

GENERAL NOTES:

- * SPECIAL REINFORCED CONCRETE TAPERED INLET TO BE CONSTRUCTED IN ACCORDANCE WITH DETAIL AND SECTION 310 OF THE STANDARD ROADWAY SPECIFICATIONS.
- * THE TAPERED INLET SHALL BE CONSTRUCTED FROM CLASS IV REINFORCED CONCRETE PIPE.
- * ALL REINFORCING STEEL SHALL HAVE A 300mm EMBEDMENT UNLESS SHOWN OTHERWISE.
- * THE TAPERED INLET SHALL BE CONSTRUCTED AS DIRECTED BY THE ENGINEER.

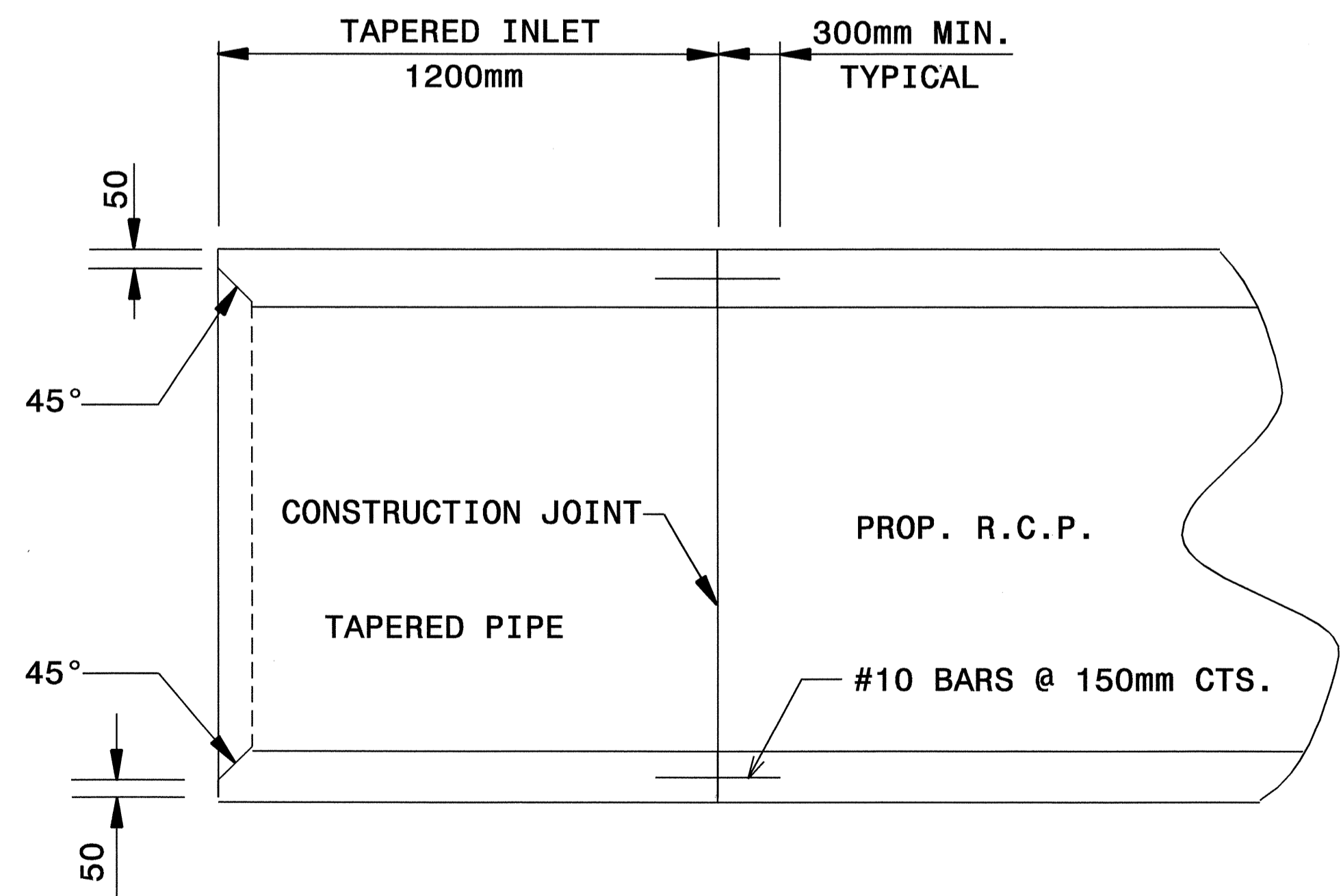
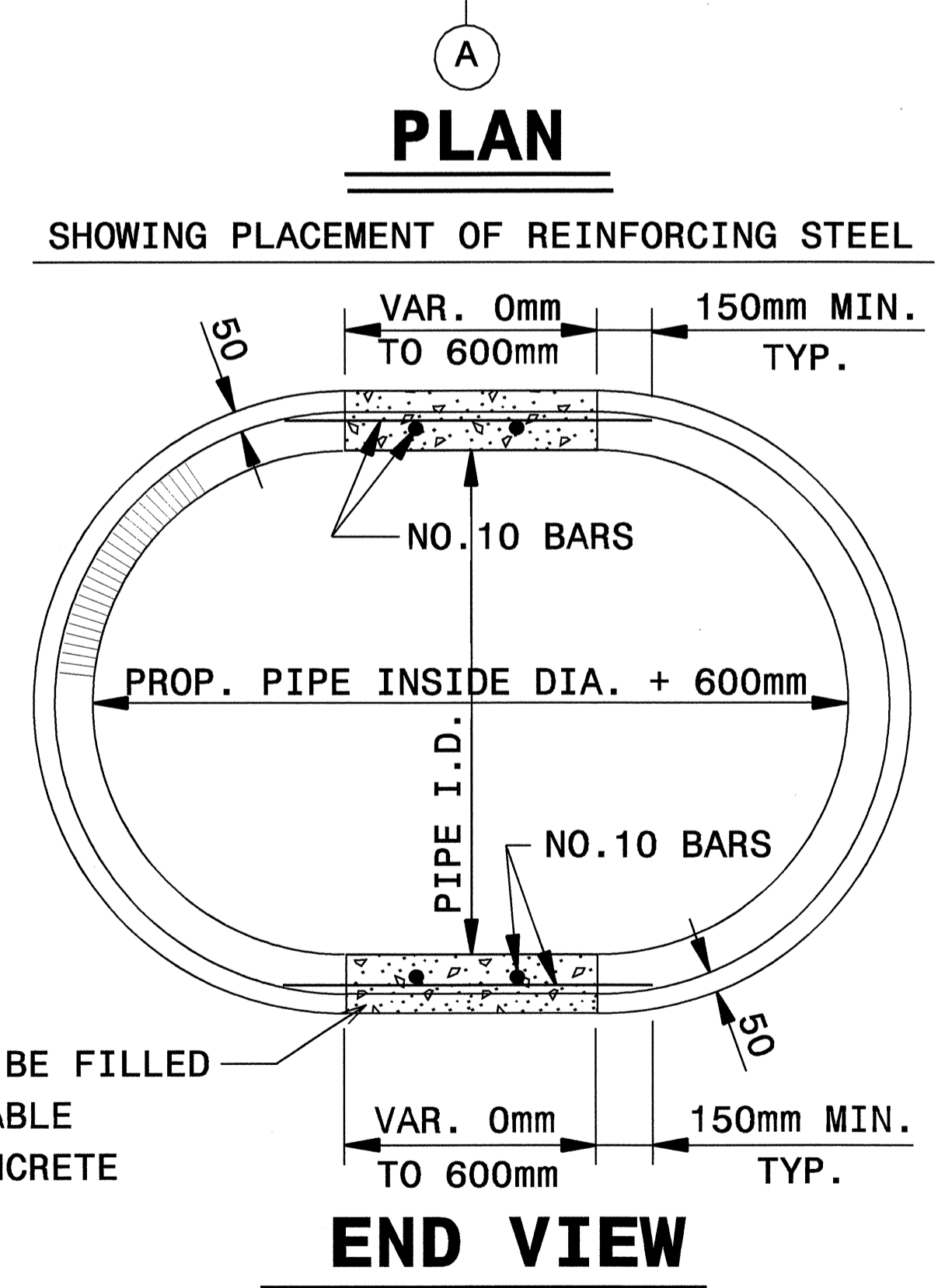

SECTION A-A

VOIDS SHALL BE FILLED WITH COMPARABLE STRENGTH CONCRETE

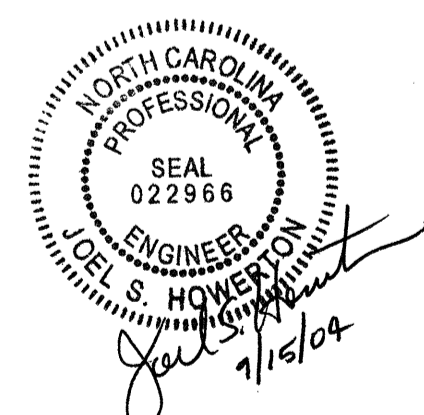

**DESIGN SERVICES UNIT
STANDARDS AND SPECIAL DESIGN**
Office 919-250-4128 FAX 919-250-4119

**DETAIL OF
REINFORCED TAPERED INLET
600mm THRU 1800mm DIAMETER**

ORIGINAL BY: ERIC E. WARD DATE: 6-24-02
 MODIFIED BY: DATE:
 CHECKED BY: DATE: 8/12/04
 FILE SPEC.: ds172:\usr\details\metric\stand\tapin1.dgn

10-AUG-2004 16:24
 W:\Special\Details\stand\metric\tapin1.dgn
 .xsp11 - All 05203055