

GRADE DATA

-2.3957% Δ +1.5090%

PI STA. = 201+20.000 -L-
ELEV. = 244.063
VC = 200.000

HORIZONTAL CURVE DATA

P.I. STA. = 199+75.908 -L-
 Δ = 25°-54'-22.0" (RT.)
 L = 1356.441m
 T = 690.016m
 R = 3000.000m

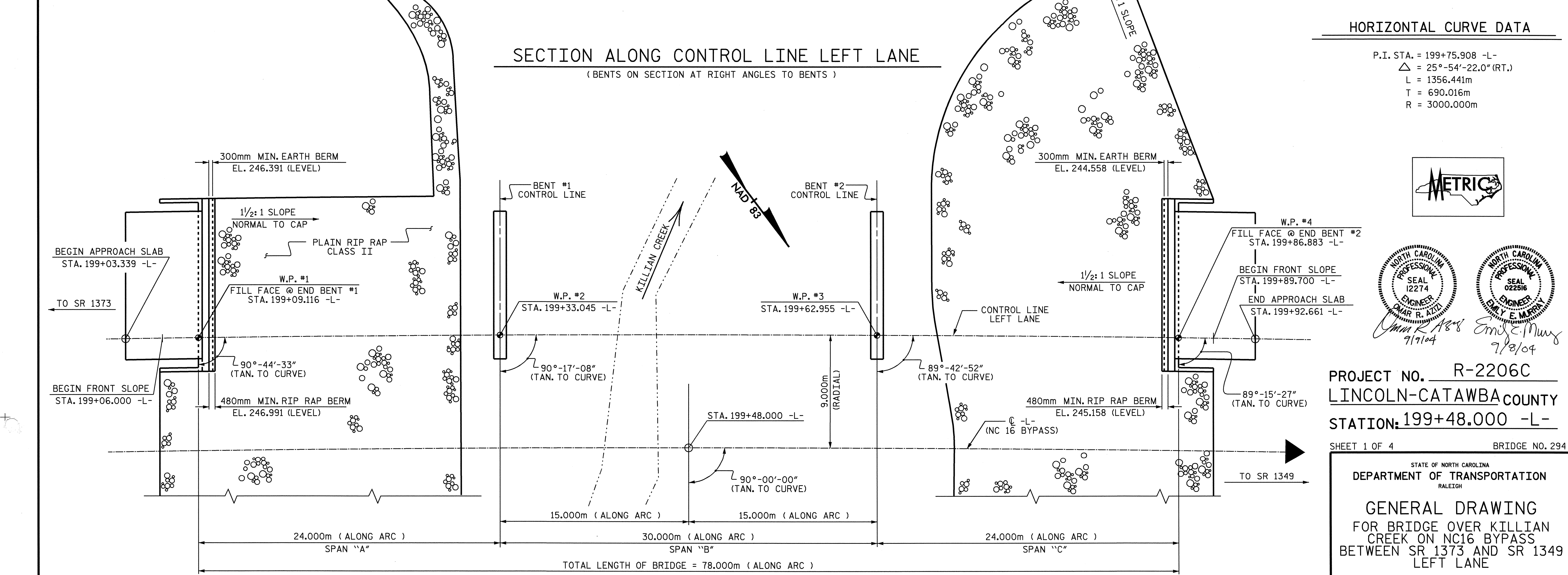
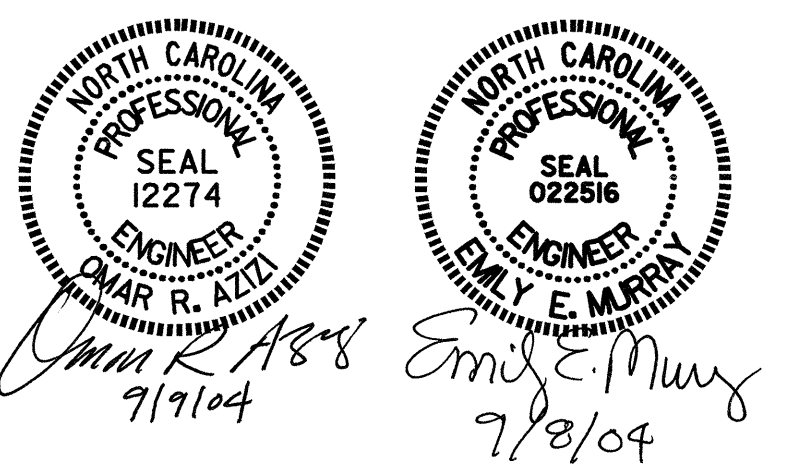
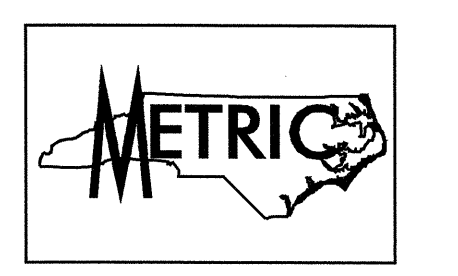

PROJECT NO. R-2206C
 LINCOLN-CATAWBA COUNTY
 STATION: 199+48.000 -L-
 SHEET 1 OF 4 BRIDGE NO. 294

STATE OF NORTH CAROLINA
 DEPARTMENT OF TRANSPORTATION
 RALEIGH

GENERAL DRAWING
 FOR BRIDGE OVER KILLIAN
 CREEK ON NC16 BYPASS
 BETWEEN SR 1373 AND SR 1349
 LEFT LANE

REVISIONS						SHEET NO.	
NO.	BY:	DATE:	NO.	BY:	DATE:	3-32	
1			3			TOTAL SHEETS	
2			4			374	

DRAWN BY: T.L. AVERETTE DATE: 2-25-02
 CHECKED BY: PEGGY ADKINS DATE: 6-04

PLAN
 (PILES NOT SHOWN FOR CLARITY)