

PROJECT REFERENCE NO. R-2206C		SHEET NO. EC-38/CONST.38	
R/W SHEET NO.			
ROADWAY DESIGN ENGINEER		HYDRAULICS ENGINEER	
CONST. REV.			
R/W REV.			

NOTE:  
PLACE TEMPORARY ROCK SEDIMENT DAMS TYPE-B AND TEMPORARY ROCK SILT CHECKS TYPE-A AT DRAINAGE OUTLETS.

CLEARING AND GRUBBING EROSION CONTROL FOR CONSTRUCTION SHEET 38

MATCHLINE SEE SHEET 21 -Y14- STA. 17+80.000

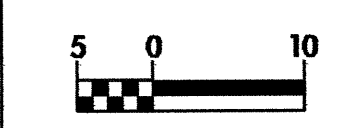

JOSEPHINE G. SCHRONCE  
DB 1665 PG 811

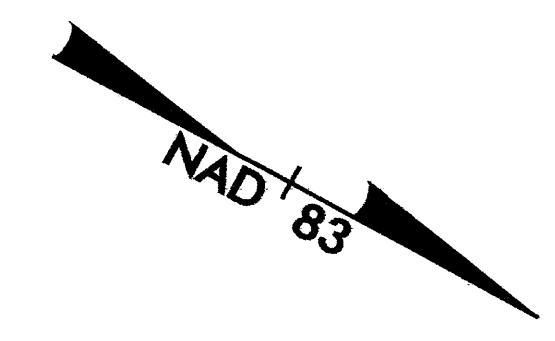

-Y14-  
PI Sta 15+40.904  
Δ = 10° 07' 29.0" (LT)  
L = 989.574  
T = 496.078  
R = 5,600.000  
e = NC

-Y14DET-  
PI Sta 17+65.452    PI Sta 19+08.197  
Δ = 14° 32' 38.1" (LT)    Δ = 9° 41' 25.1" (RT)  
L = 82.498    L = 202.953  
T = 41.472    T = 101.719  
R = 325.000    R = 1,200.000

ROGER STEVE LEE  
ROGER LEE  
DB 1218 PG 786  
(LINCOLN COUNTY)

ROGER STEVE LEE  
DB 2249 PG 366  
(CATAWBA COUNTY)

17 x 8 x 1  
2 weir

VAR. WIDTH BASE DITCH  
W/CL #1 RIP RAP  
EST. 31 MTONS  
FILTER FABRIC  
EST. 48 SM  
EST. DDE = ?  
(SEE DETAIL ?)

0.9m LAT. BASE DITCH  
W/CL #1 RIP RAP  
EST. 78 MTONS  
FILTER FABRIC  
EST. 123 SM  
EST. DDE = ?  
(SEE DETAIL ?)

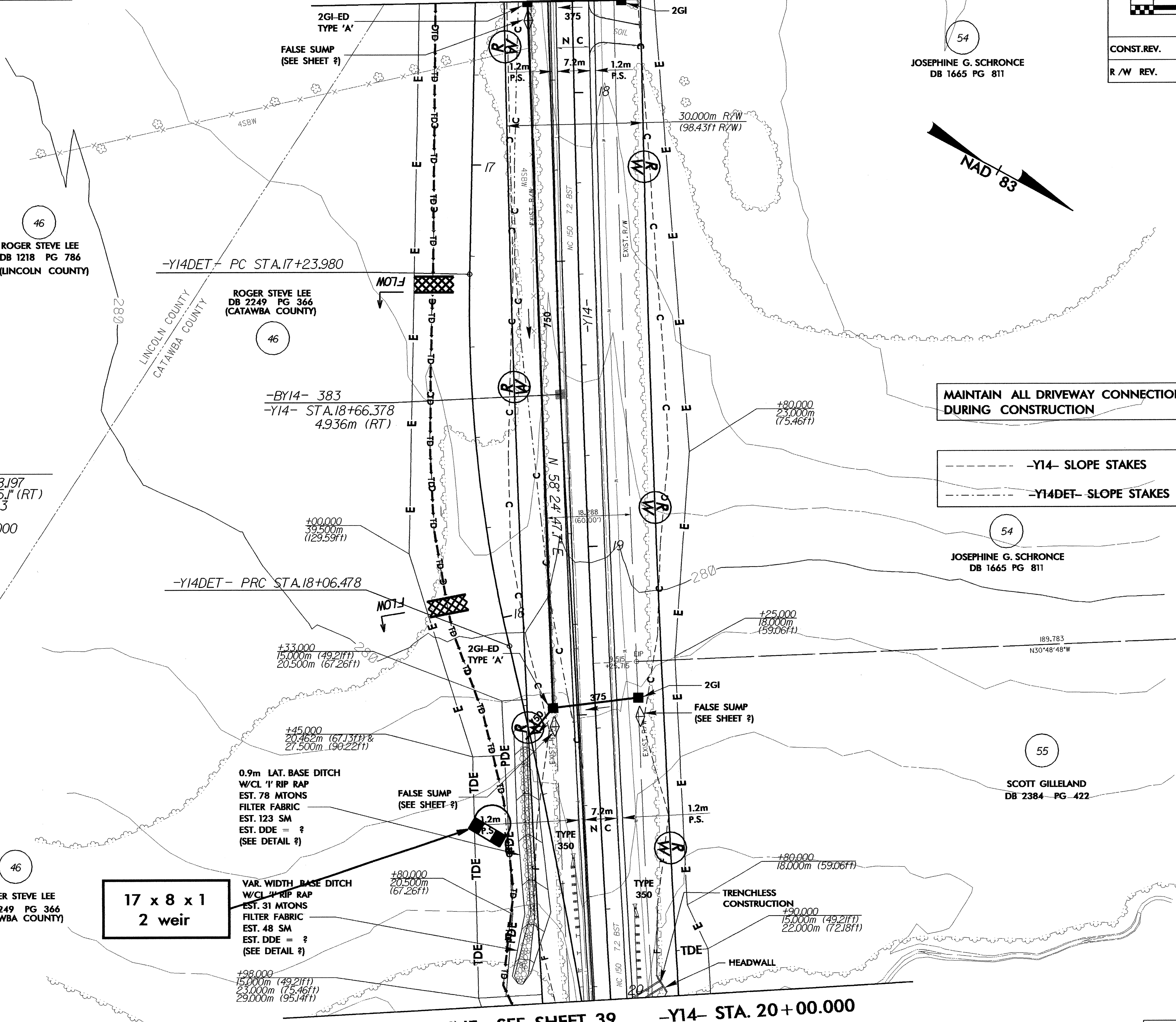

MATCHLINE SEE SHEET 39 -Y14- STA. 20+00.000

SEE SHEETS 76 & 77 FOR -Y14- PROFILE  
SEE SHEETS 46, 47 & 48 FOR -Y14- DETOUR  
SEE SHEETS 77 & 78 FOR -Y14DET- PROFILE