

See Sheet 1-B For Symbology Sheet

T.I.P. NO.	SHEET NO.
R-2417BB	UO-1

STATE OF NORTH CAROLINA
DIVISION OF HIGHWAYS

**UTILITY BY OTHERS PLANS
LEE COUNTY**

**LOCATION: US 421 / NC 87 (SANFORD BYPASS)
FROM EAST OF SR 1521 (KELLY DRIVE)
TO EAST OF NC 42**

TYPE OF WORK: UTILITIES BY OTHERS

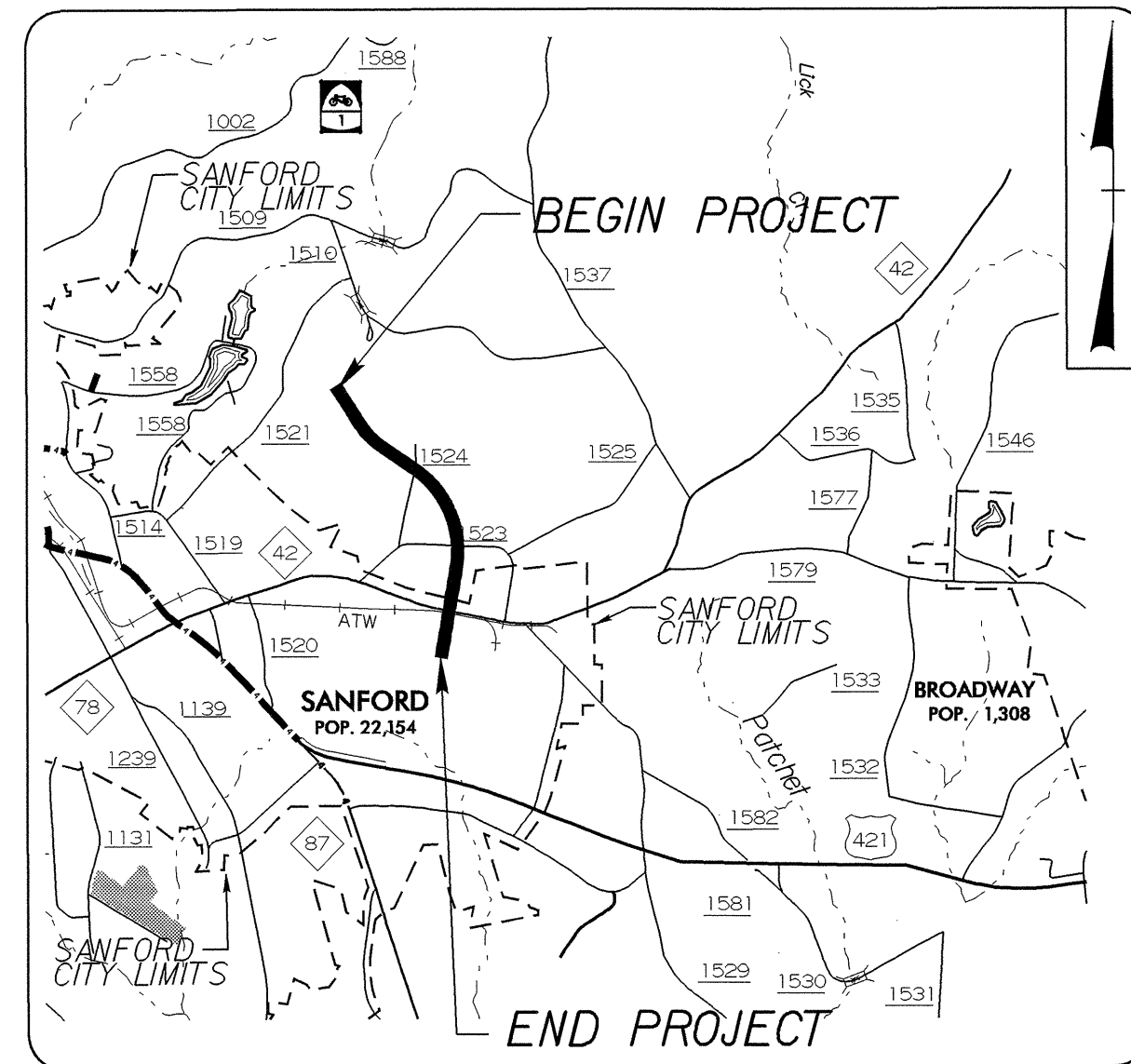

VICINITY MAP

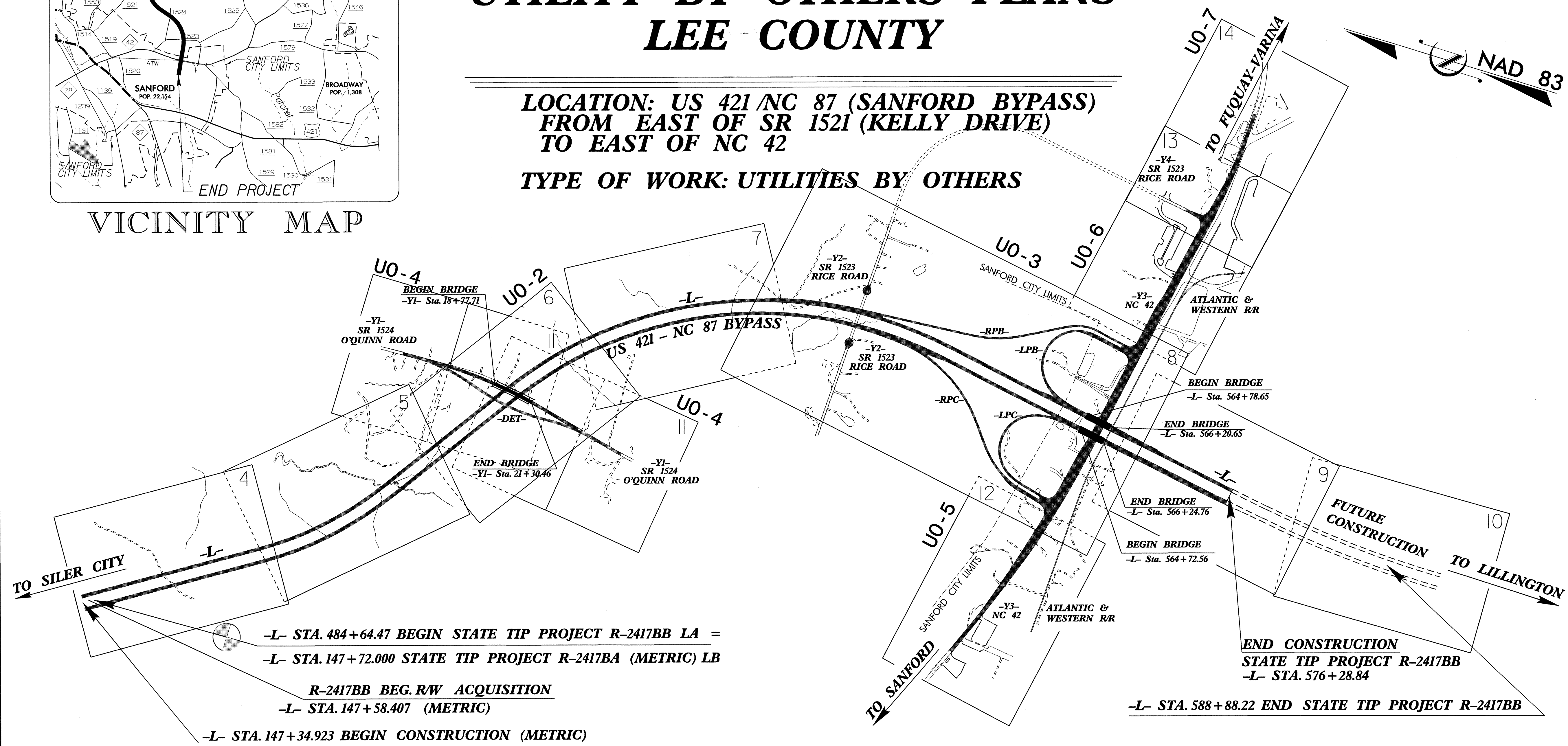
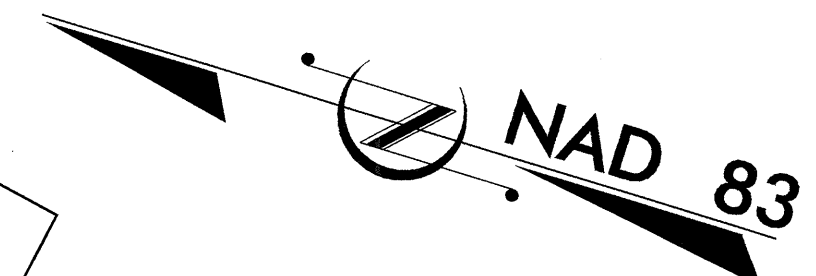

-L- STA. 484+64.47 BEGIN STATE TIP PROJECT R-2417BB LA =
-L- STA. 147+72.000 STATE TIP PROJECT R-2417BA (METRIC) LB
R-2417BB BEG. R/W ACQUISITION
-L- STA. 147+58.407 (METRIC)
-L- STA. 147+34.923 BEGIN CONSTRUCTION (METRIC)

END CONSTRUCTION
STATE TIP PROJECT R-2417BB
-L- STA. 576+28.84
-L- STA. 588+88.22 END STATE TIP PROJECT R-2417BB

TIP: R-2417BB

INDEX OF SHEETS	
SHEET NO.	DESCRIPTION
UO-1	TITLE SHEET
UO-2 THRU UO-7	UTILITY BY OTHERS PLAN SHEETS

WATER AND SEWER OWNERS ON PROJECT
(1) WATER N/A
(2) SANITARY N/A

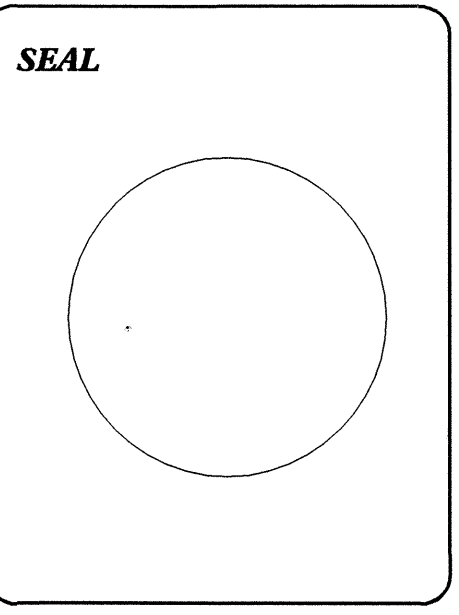

PREPARED IN THE OFFICE OF:
DIVISION OF HIGHWAYS
DESIGN SERVICES
UTILITY SECTION

1591 MAIL SERVICES CENTER
RALEIGH NC 27699-1591
PHONE (919) 250-4128
FAX (919) 250-4119

Roger Worthington, P.E.	UTILITIES SECTION ENGINEER
Greg Stevens, P.E.	UTILITIES SQUAD LEADER PROJECT ENGINEER
Ali Kouchehi	UTILITIES PROJECT DESIGNER