

10/20/17

REVISIONS	

-Y9-		-RPA-	
PI Sta 11+93.059	PI Sta 13+02.664	PI Sta 14+22.850	PI Sta 15+44.757
$\Delta = 27^\circ 37' 27.1''$ (LT)	$\Delta = 5^\circ 09' 23.8''$	$\Delta = 14^\circ 17' 58.5''$	$\Delta = 89^\circ 02' 04.7''$ (LT)
$L = 60.000$	$L = 131.641$	$L = 60.000$	$L = 62.116$
$T = 61.8770$	$T = 60.000$	$T = 60.000$	$T = 62.116$
$R = 460.000$	$R = 460.000$	$R = 460.000$	$R = 175.000$
$SE = 0.08$ (SEE PLANS)	$SE = 0.08$	$SE = 0.08$	$SE = 0.08$ (SEE PLANS)

-RPB-	
PI Sta 10+40.009	PI Sta 11+26.273
$\Delta = 14^\circ 12' 12.1''$	$\Delta = 16^\circ 27' 47.7''$ (LT)
$L = 60.000$	$L = 62.273$
$T = 40.000$	$T = 40.000$
$SE = 0.08$	$SE = 0.08$

-RPC-	
PI Sta 11+40.009	PI Sta 12+11.649
$\Delta = 14^\circ 12' 12.1''$	$\Delta = 16^\circ 27' 47.7''$ (LT)
$L = 60.000$	$L = 62.273$
$T = 40.000$	$T = 40.000$
$SE = 0.08$	$SE = 0.08$

-RPC-	
PI Sta 12+11.649	PI Sta 13+13.477
$\Delta = 16^\circ 27' 47.7''$ (LT)	$\Delta = 17^\circ 13' 23.6''$ (RT)
$L = 60.000$	$L = 71.828$
$T = 40.000$	$T = 67.789$
$SE = 0.08$ (SEE PLANS)	$SE = 0.08$ (SEE PLANS)

-RPC-	
PI Sta 13+13.477	PI Sta 14+13.468
$\Delta = 17^\circ 13' 23.6''$ (RT)	$\Delta = 11^\circ 48' 48.8''$
$L = 60.000$	$L = 60.000$
$T = 40.000$	$T = 40.000$
$SE = 0.08$ (SEE PLANS)	$SE = 0.08$ (SEE PLANS)

-RPC-	
PI Sta 14+13.468	PI Sta 15+28.377
$\Delta = 11^\circ 48' 48.8''$	$\Delta = 37^\circ 59' 07.3''$ (LT)
$L = 60.000$	$L = 114.909$
$T = 40.000$	$T = 62.116$
$SE = 0.08$ (SEE PLANS)	$SE = 0.08$ (SEE PLANS)

-RPC-	
PI Sta 15+28.377	PI Sta 16+17.022
$\Delta = 37^\circ 59' 07.3''$ (LT)	$\Delta = 11^\circ 48' 48.8''$
$L = 114.909$	$L = 60.000$
$T = 62.116$	$T = 40.000$
$SE = 0.08$ (SEE PLANS)	$SE = 0.08$ (SEE PLANS)

-RPC-	
PI Sta 16+17.022	PI Sta 17+02.000
$\Delta = 11^\circ 48' 48.8''$	$\Delta = 16^\circ 27' 47.7''$ (LT)
$L = 60.000$	$L = 60.000$
$T = 40.000$	$T = 40.000$
$SE = 0.08$ (SEE PLANS)	$SE = 0.08$ (SEE PLANS)

-RPC-	
PI Sta 17+02.000	PI Sta 18+00.000
$\Delta = 16^\circ 27' 47.7''$ (LT)	$\Delta = 16^\circ 27' 47.7''$ (LT)
$L = 60.000$	$L = 60.000$
$T = 40.000$	$T = 40.000$
$SE = 0.08$ (SEE PLANS)	$SE = 0.08$ (SEE PLANS)

-RPC-	
PI Sta 18+00.000	PI Sta 19+00.000
$\Delta = 16^\circ 27' 47.7''$ (LT)	$\Delta = 16^\circ 27' 47.7''$ (LT)
$L = 60.000$	$L = 60.000$
$T = 40.000$	$T = 40.000$
$SE = 0.08$ (SEE PLANS)	$SE = 0.08$ (SEE PLANS)

-RPC-	
PI Sta 19+00.000	PI Sta 20+00.000
$\Delta = 16^\circ 27' 47.7''$ (LT)	$\Delta = 16^\circ 27' 47.7''$ (LT)
$L = 60.000$	$L = 60.000$
$T = 40.000$	$T = 40.000$
$SE = 0.08$ (SEE PLANS)	$SE = 0.08$ (SEE PLANS)

-RPC-	
PI Sta 20+00.000	PI Sta 21+00.000
$\Delta = 16^\circ 27' 47.7''$ (LT)	$\Delta = 16^\circ 27' 47.7''$ (LT)
$L = 60.000$	$L = 60.000$
$T = 40.000$	$T = 40.000$
$SE = 0.08$ (SEE PLANS)	$SE = 0.08$ (SEE PLANS)

-RPC-	
PI Sta 21+00.000	PI Sta 22+00.000
$\Delta = 16^\circ 27' 47.7''$ (LT)	$\Delta = 16^\circ 27' 47.7''$ (LT)
$L = 60.000$	$L = 60.000$
$T = 40.000$	$T = 40.000$
$SE = 0.08$ (SEE PLANS)	$SE = 0.08$ (SEE PLANS)

-RPC-	
PI Sta 22+00.000	PI Sta 23+00.000
$\Delta = 16^\circ 27' 47.7''$ (LT)	$\Delta = 16^\circ 27' 47.7''$ (LT)
$L = 60.000$	$L = 60.000$
$T = 40.000$	$T = 40.000$
$SE = 0.08$ (SEE PLANS)	$SE = 0.08$ (SEE PLANS)

-RPC-	
PI Sta 23+00.000	PI Sta 24+00.000
$\Delta = 16^\circ 27' 47.7''$ (LT)	$\Delta = 16^\circ 27' 47.7''$ (LT)
$L = 60.000$	$L = 60.000$
$T = 40.000$ <td $T = 40.000$	
$SE = 0.08$ (SEE PLANS)	$SE = 0.08$ (SEE PLANS)

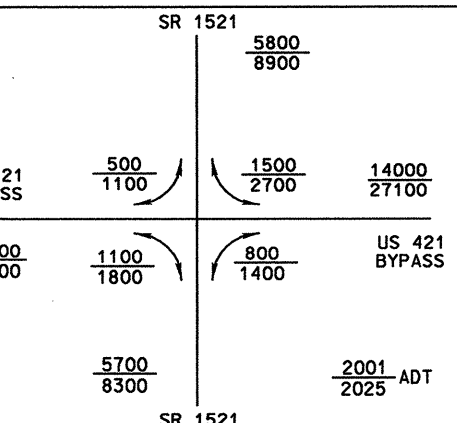
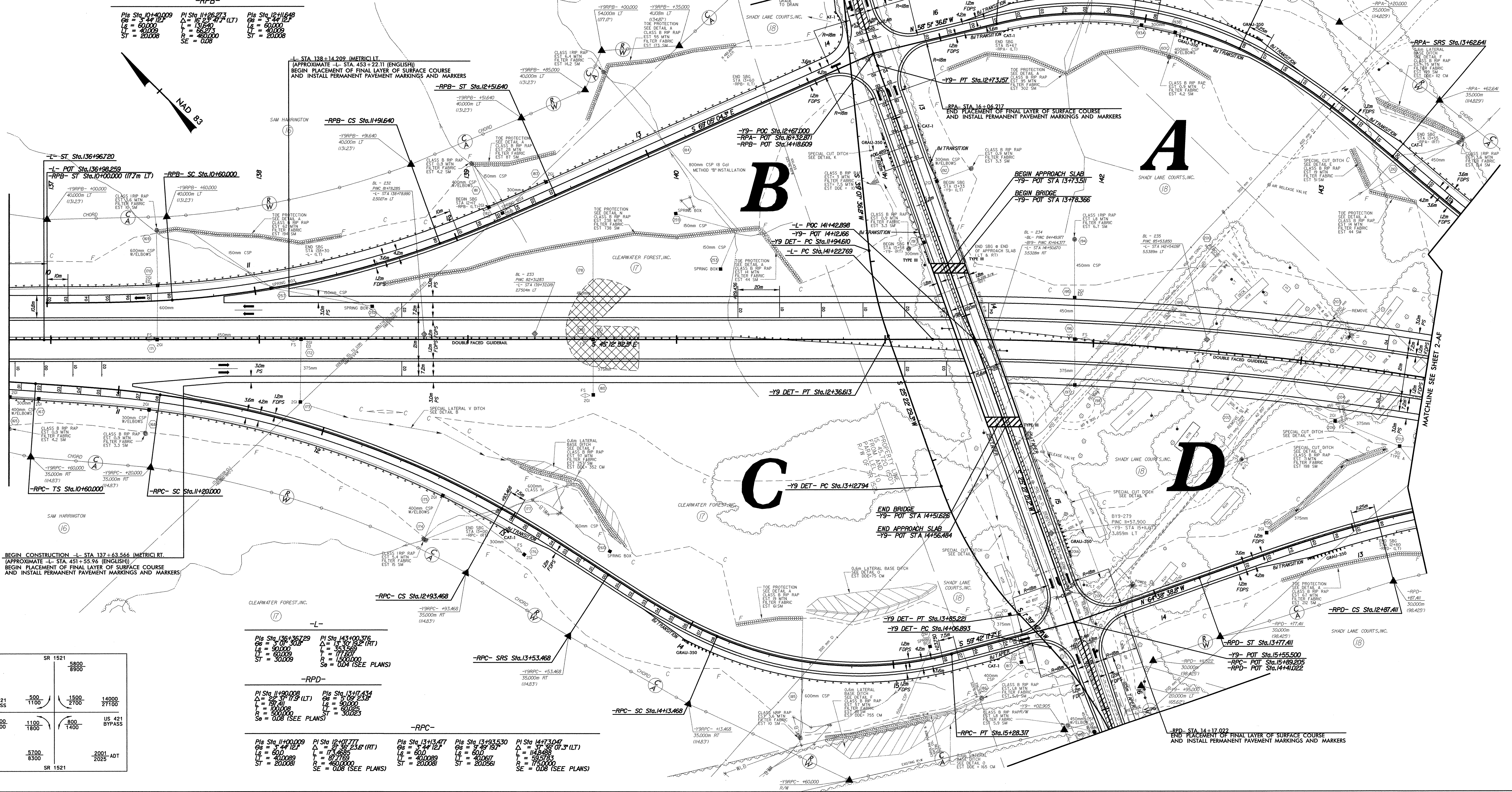

**METRICS**

PROJECT REFERENCE NO. **R-24789** SHEET NO. **2-4E**

R/W SHEET NO.

ROADWAY DESIGN ENGINEER

HYDRAULICS ENGINEER

NOT A DESIGN DOCUMENT AS IT DOES NOT SHOW THE LOCATION OF THE ROADWAY OR THE ROADWAY'S WIDTH AND LOCATION. THIS DOCUMENT IS FOR INFORMATION ONLY.

CONSTRY.

R/W REV.

THIS DOCUMENT IS NOT TO BE USED FOR ANY OTHER PROJECT WITHOUT THE WRITTEN CONSENT OF METRICS.

MATCHLINE SEE SHEET 2-AF