

18+75 19+00 19+25 19+50 19+75 20+00 20+25 20+50 20+75 21+00

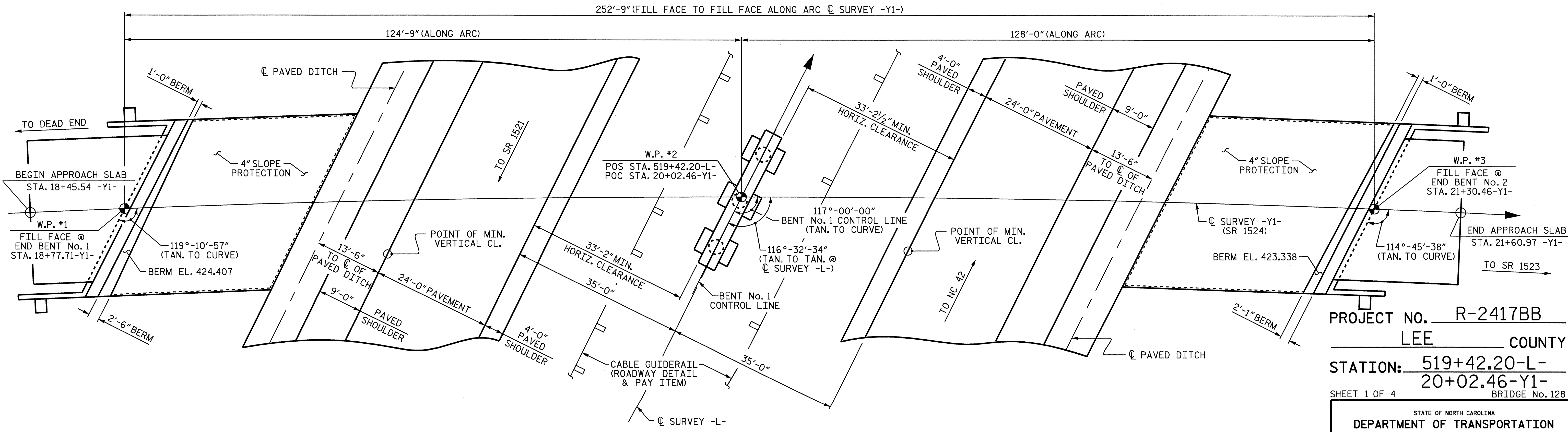
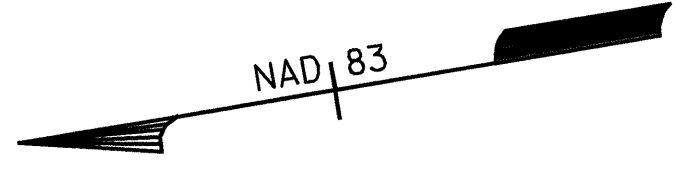
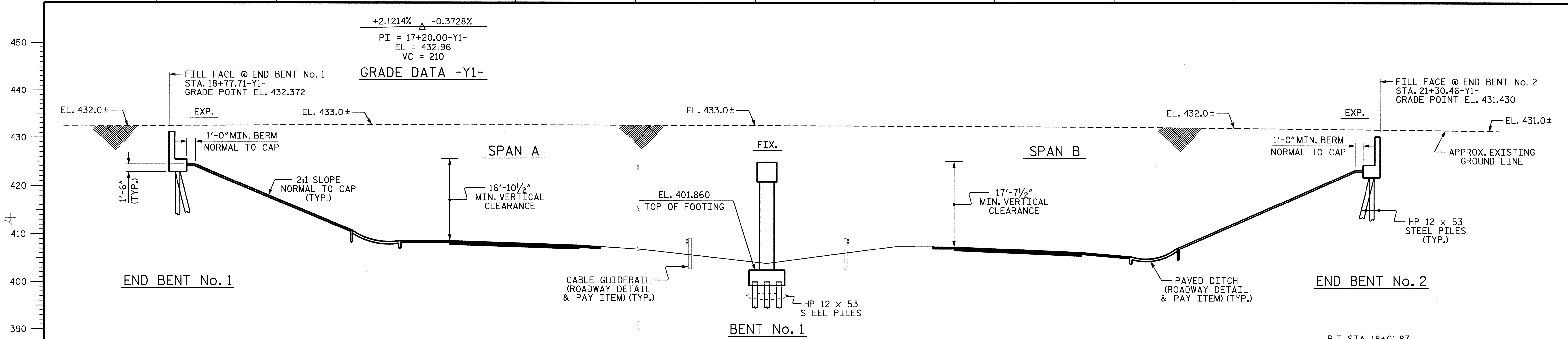

PLAN
 (PILES FOR END BENTS AND BENTS NOT SHOWN FOR CLARITY)

PROJECT NO. R-2417BB
LEE COUNTY
 STATION: 519+42.20-L-
20+02.46-Y1-
 SHEET 1 OF 4 BRIDGE No. 128

STATE OF NORTH CAROLINA
 DEPARTMENT OF TRANSPORTATION
 RALEIGH
GENERAL DRAWING
 FOR BRIDGE OVER US 421-NC 87
 SANFORD BYPASS ON
 SR 1524 (O'QUINN ROAD)
 BETWEEN DEAD END AND SR 1523

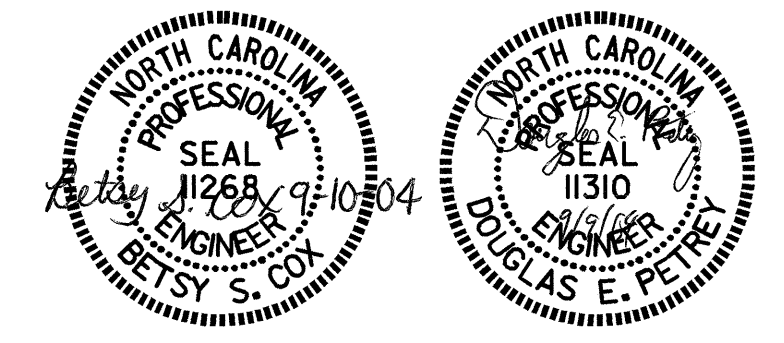

DRAWN BY: B.N. GRADY DATE: 1-04
 CHECKED BY: P.C. BREWER DATE: 7/04

REVISIONS						SHEET NO. S-1
NO.	BY:	DATE:	NO.	BY:	DATE:	
1			3			TOTAL SHEETS 78
2			4			