

TIP PROJECT: B-3475

STATE OF NORTH CAROLINA
 DIVISION OF HIGHWAYS
 PLAN FOR PROPOSED
 HIGHWAY EROSION CONTROL
HENDERSON COUNTY

**LOCATION: BRIDGE NO. 356 OVER WASH CREEK ON
 SR 1127 (KANUGA RD.) IN HENDERSONVILLE**

**TYPE OF WORK: GRADING, DRAINAGE, PAVING, CULVERT,
 & SIGNALS**

**BEG. CONSTRUCTION
 -Y1- STA 11+60**

STA 10+10.00 -L- BEGIN TIP PROJECT B-3475

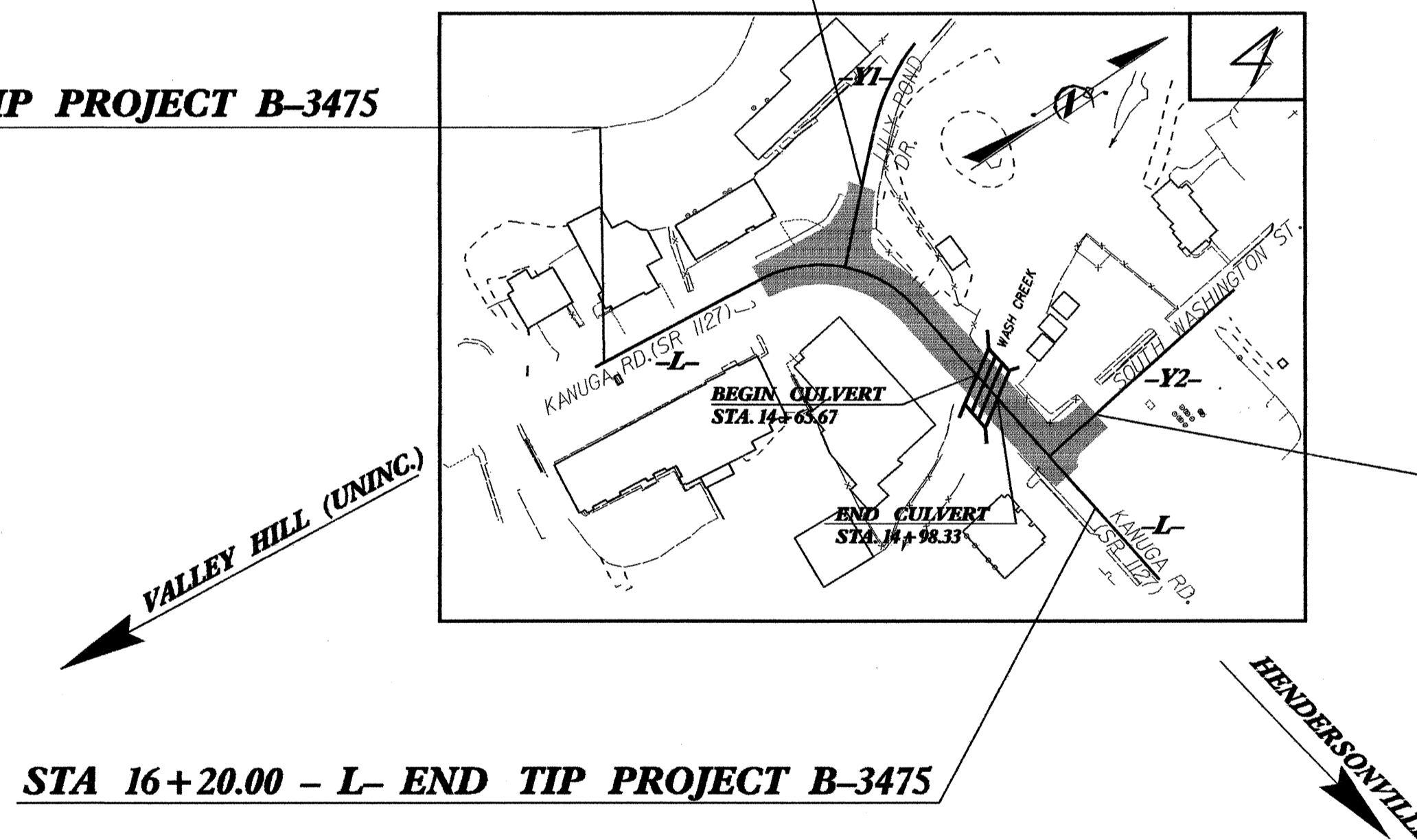

**BEGIN CONSTRUCTION
 -Y2- STA 11+94**

STA 16+20.00 - L- END TIP PROJECT B-3475

| STATE | STATE PROJECT REFERENCE NO. | SHEET NO. | TOTAL SHEETS |
|-----------------|-----------------------------|-------------|--------------|
| N.C. | B-3475 | EC-1 | |
| STATE PROJ. NO. | F.A. PROJ. NO. | DESCRIPTION | |
| | | | |
| | | | |
| | | | |
| | | | |
| | | | |

EROSION AND SEDIMENT CONTROL MEASURES

| Std. # | Description | Symbol |
|---------|--------------------------------------|--------|
| | Reforestation | |
| 1650.05 | Temporary Silt Ditch | |
| 1650.05 | Temporary Diversion | |
| 1605.01 | Temporary Silt Fence | |
| 1606.01 | Special Sediment Control Fence | |
| 1622.01 | Temporary Berms and Slope Drains | |
| 1650.01 | Riser Basin | |
| 1650.02 | Silt Basin Type B | |
| 1653.01 | Temporary Rock Silt Check Type-A | |
| 1653.02 | Temporary Rock Silt Check Type-B | |
| 1654.01 | Temporary Rock Sediment Dam Type-A | |
| 1654.02 | Temporary Rock Sediment Dam Type-B | |
| 1655.01 | Rock Pipe Inlet Sediment Trap Type-A | |
| 1655.02 | Rock Pipe Inlet Sediment Trap Type-B | |
| 1656.01 | Rock Silt Screen | |
| 1650.04 | Stilling Basin | |
| | Rock Inlet Sediment Trap: | |
| 1652.01 | Type A | |
| 1652.02 | Type B | |
| 1652.03 | Type C | |

**THIS PROJECT CONTAINS
 EROSION CONTROL PLANS
 FOR CLEARING AND
 GRUBBING PHASE OF
 CONSTRUCTION.**

**THIS PROJECT HAS
 BEEN DESIGNED TO
 SENSITIVE WATERSHED
 STANDARDS.**

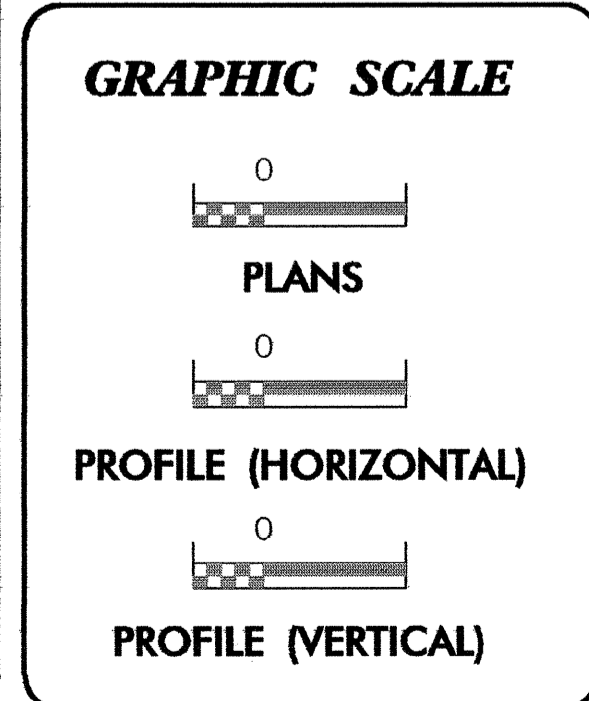

ROADSIDE ENVIRONMENTAL UNIT
 DIVISION OF HIGHWAYS
 STATE OF NORTH CAROLINA

Prepared in the Office of:
ROADSIDE ENVIRONMENTAL UNIT
 1 South Wilmington St.
 Raleigh, NC 27611
2002 STANDARD SPECIFICATIONS

Roadway Standard Drawings

The following roadway english standards as appear in "Roadway Standard Drawings"- Roadway Design Unit - N. C. Department of Transportation - Raleigh, N. C., dated January 20, 2002 and the latest revision thereto are applicable to this project and by reference hereby are considered a part of these plans.

| | |
|------------------------------|--|
| 1605.01 Temporary Silt Fence | 1632.03 Rock Inlet Sediment Trap Type C |
| 1630.04 Stilling Basin | 1633.01 Temporary Rock Silt Check Type A |
| | 1633.02 Temporary Rock Silt Check Type A |
| | 1634.02 Temporary Rock Sediment Dam Type B |