

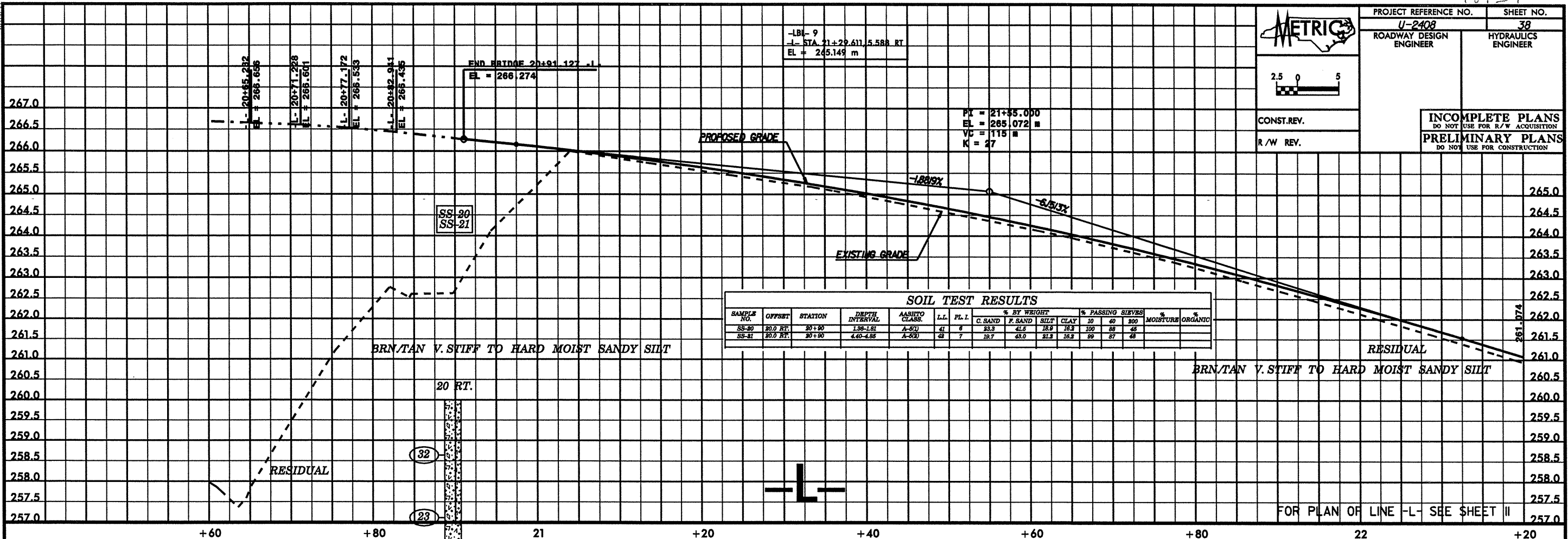

CONST.REV.  
R/W REV.

**INCOMPLETE PLANS**  
DO NOT USE FOR R/W ACQUISITION

**PRELIMINARY PLANS**  
DO NOT USE FOR CONSTRUCTION



**SOIL TEST RESULTS**

SAMPLE NO.	OFFSET	STATION	DEPTH INTERVAL	AASHTO CLASS.	L.L.	P.L.	% BY WEIGHT				% PASSING SIEVES			% MOISTURE	% ORGANIC
							C. SAND	F. SAND	SILT	CLAY	#10	#60	#200		
SS-20	20.0 RT.	20+90	1.36-1.51	A-2(1)	41	6	33.3	41.5	12.5	12.7	100	68	45		
SS-21	20.0 RT.	20+90	4.40-4.85	A-2(2)	48	7	32.7	48.0	21.3	12.3	89	57	48		

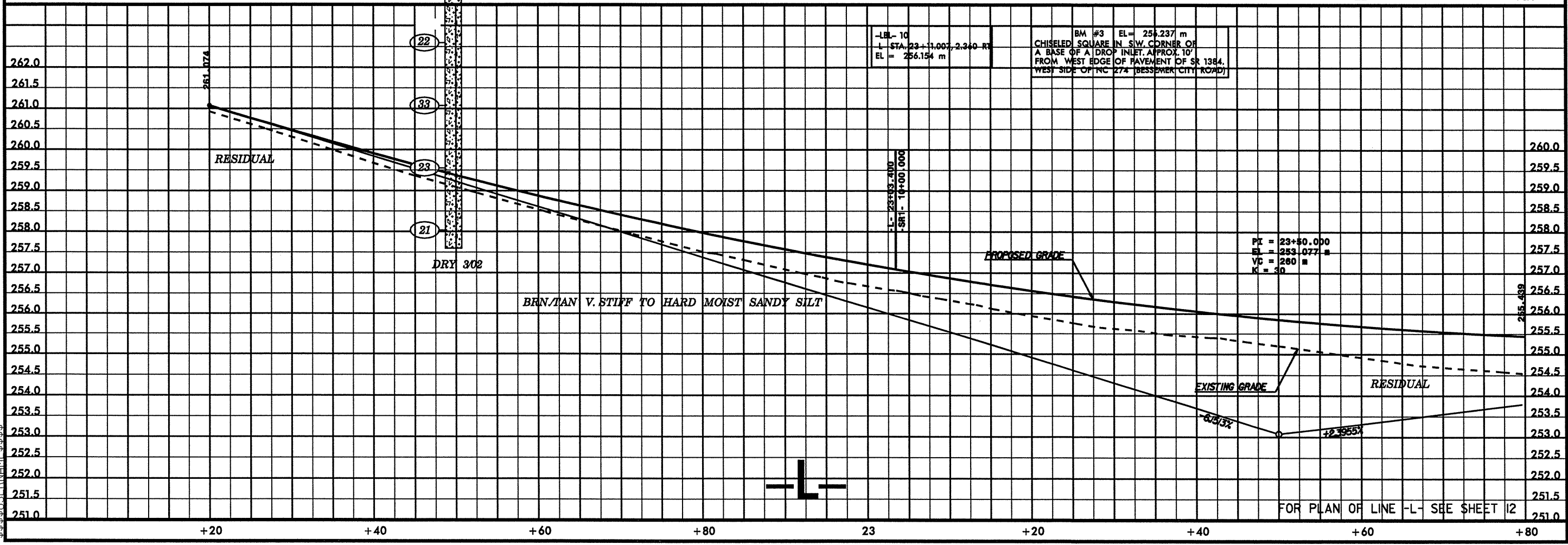

-L-10  
L STA. 23+1.000, 2.3+0 RT  
EL = 256.154 m

BM #3 EL = 254.237 m  
CHISELED SQUARE IN S.W. CORNER OF  
A BASE OF A DROP INLET, APPROX. 10'  
FROM WEST EDGE OF PAVEMENT OF SR 1364,  
WEST SIDE OF NC 274 (BESSEMER CITY ROAD)

PI = 23+50.000  
EL = 253.077 m  
VC = 260 m  
K = 30

\$\$\$SYSTIME\$\$\$  
 \$\$\$DGN\$\$\$  
 \$\$\$USERNAME\$\$\$

FOR PLAN OF LINE -L- SEE SHEET 11

FOR PLAN OF LINE -L- SEE SHEET 12