

THE 8" SEWER LINE OWNED BY THE DURHAM COUNTY.

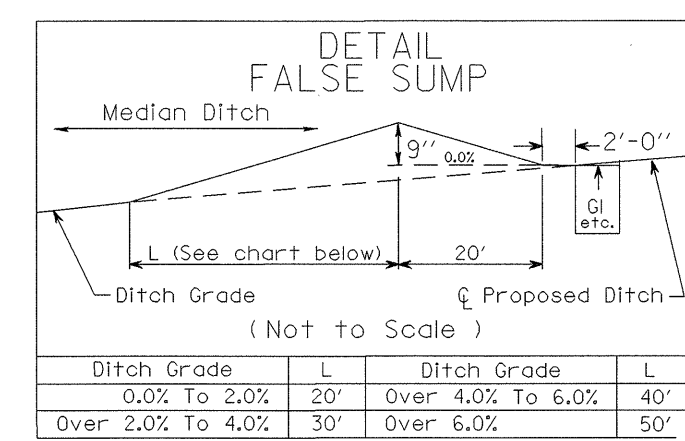
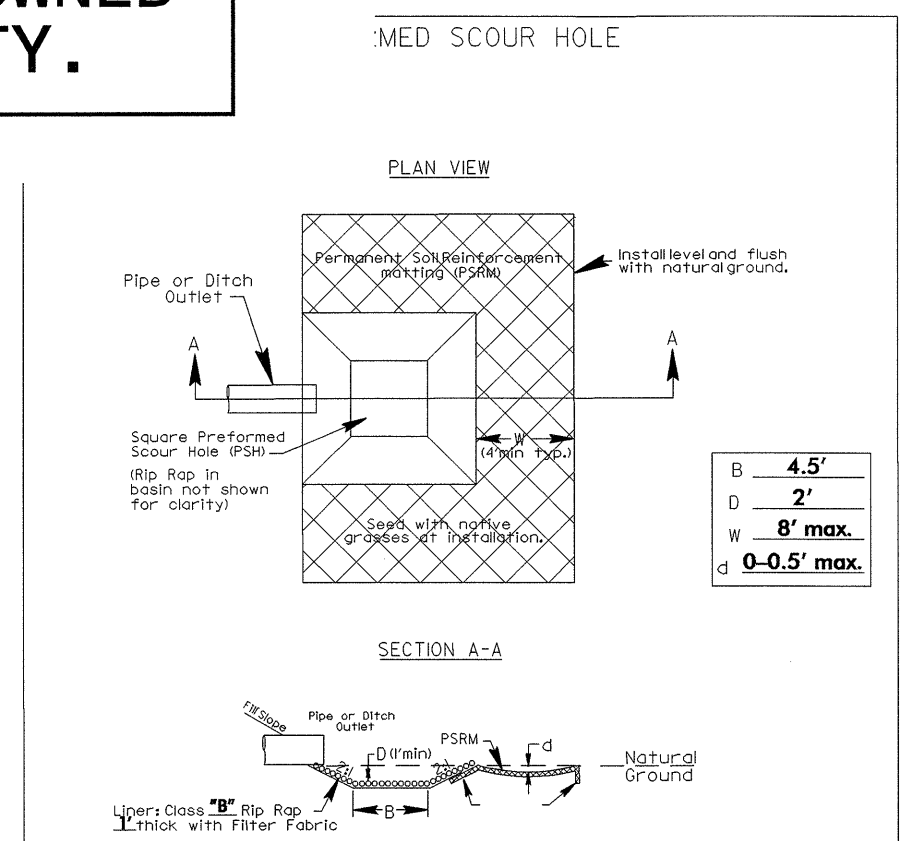

Ditch Grade	L	Ditch Grade	L
0.0% To 2.0%	20'	Over 4.0% To 6.0%	40'
Over 2.0% To 4.0%	30'	Over 6.0%	50'

-L-
 PIs Sta 23+02.76 PI Sta 25+79.89 PIs Sta 28+55.34
 Fs = 3'00" 56.0" Δ = 12' 38" 33.8" (RT) Fs = 3'00" 56.0"
 Ls = 200.00 D = 3'00" 56.0" Ls = 200.00
 LT = 133.35 L = 419.25 LT = 133.35

THE 16" WATER LINE OWNED BY CITY OF DURHAM.

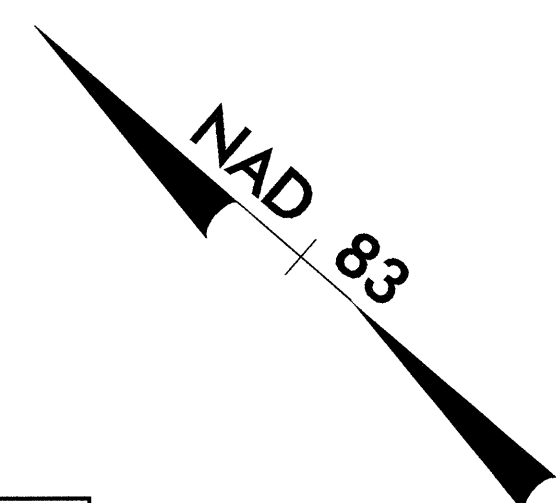

UTILITY CONSTRUCTION

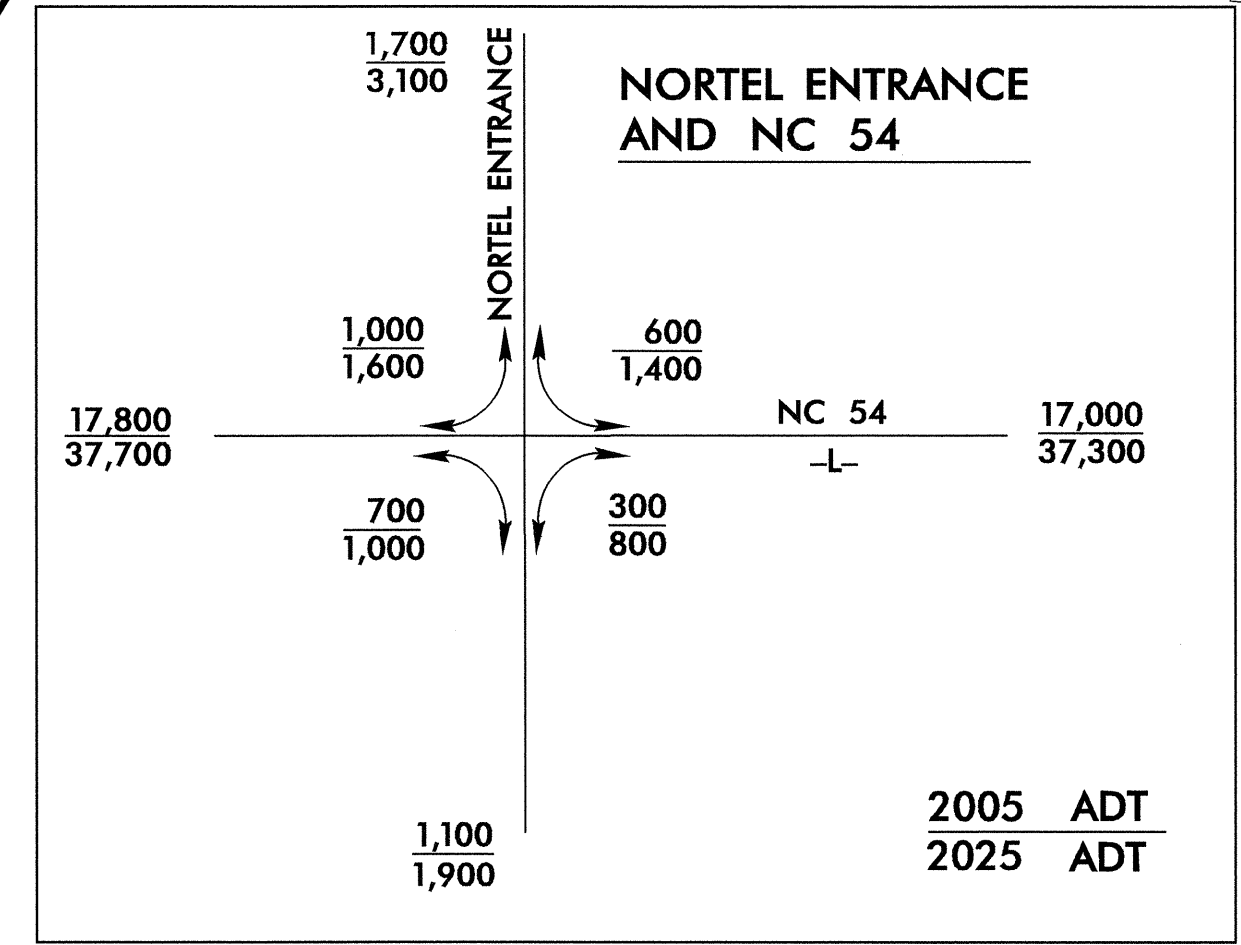
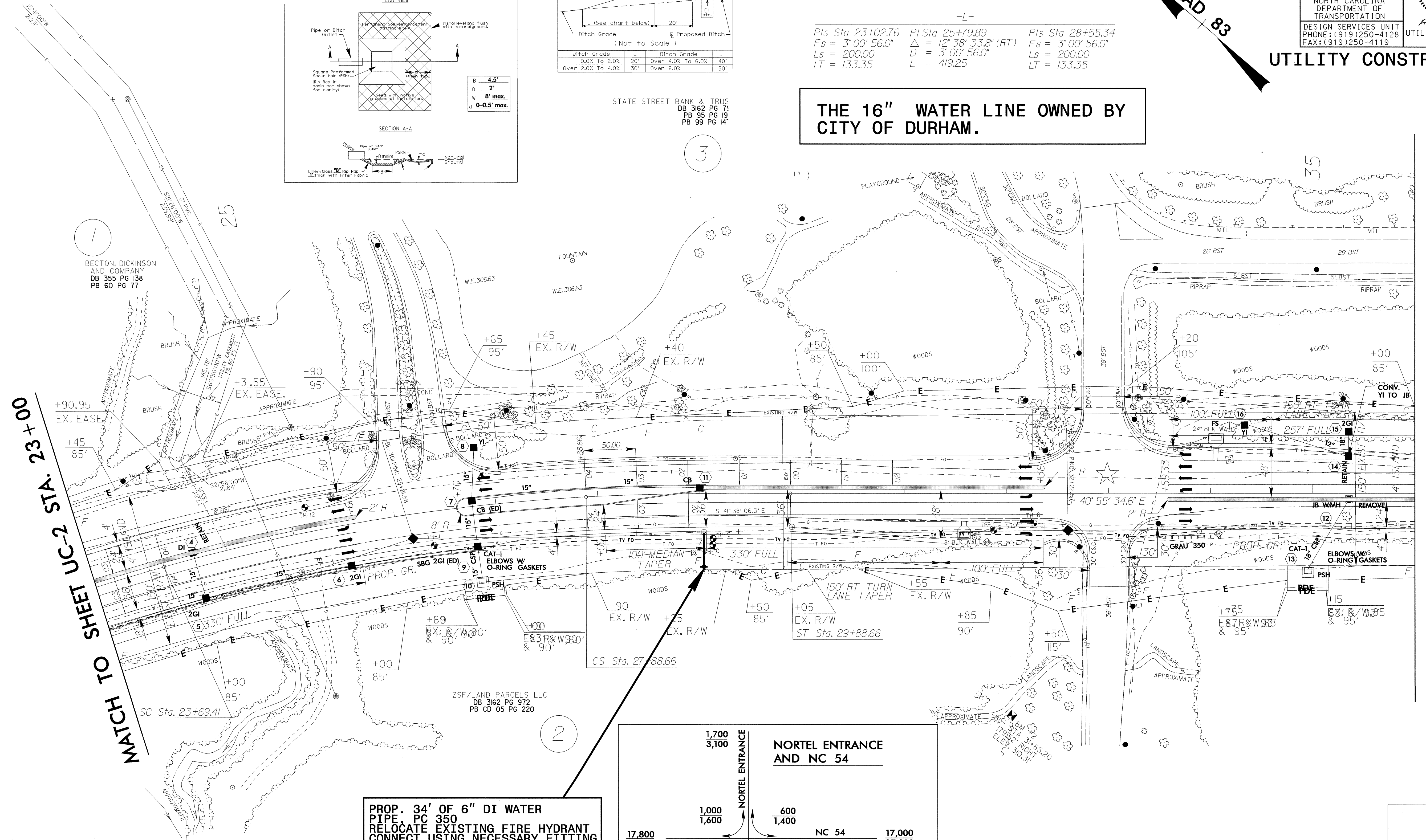

PROP. 34' OF 6" DI WATER PIPE, PC 350 RELOCATE EXISTING FIRE HYDRANT CONNECT USING NECESSARY FITTING

☆ EXIST. SIGNAL
 FOR -L- PROFILE SEE SHEET 8
 PSH: PREFORMED SCOUR HOLE (SEE DETAIL)
 SBG: SHOULDER BERM GUTTER

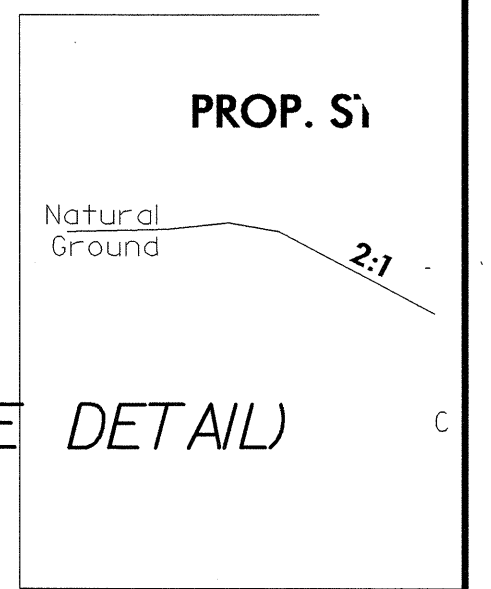

MATCH TO SHEET UC-2 STA. 23+00

MATCH TO SHEET UC-4 STA. 36+00

REVISIONS

03-AUG-2004 15:35 R:\Utilities\Job\UC3\Prop\2904_UC3.DGN