

FRONT FACE OF WALL
N.T.S.

ESTIMATED QUANTITIES	
SELECT GRANULAR MATERIAL FOR	
TEMPORARY FABRIC WALL.....	3000 m ³
FABRIC FOR TEMPORARY FABRIC WALL.....	10000 m ²

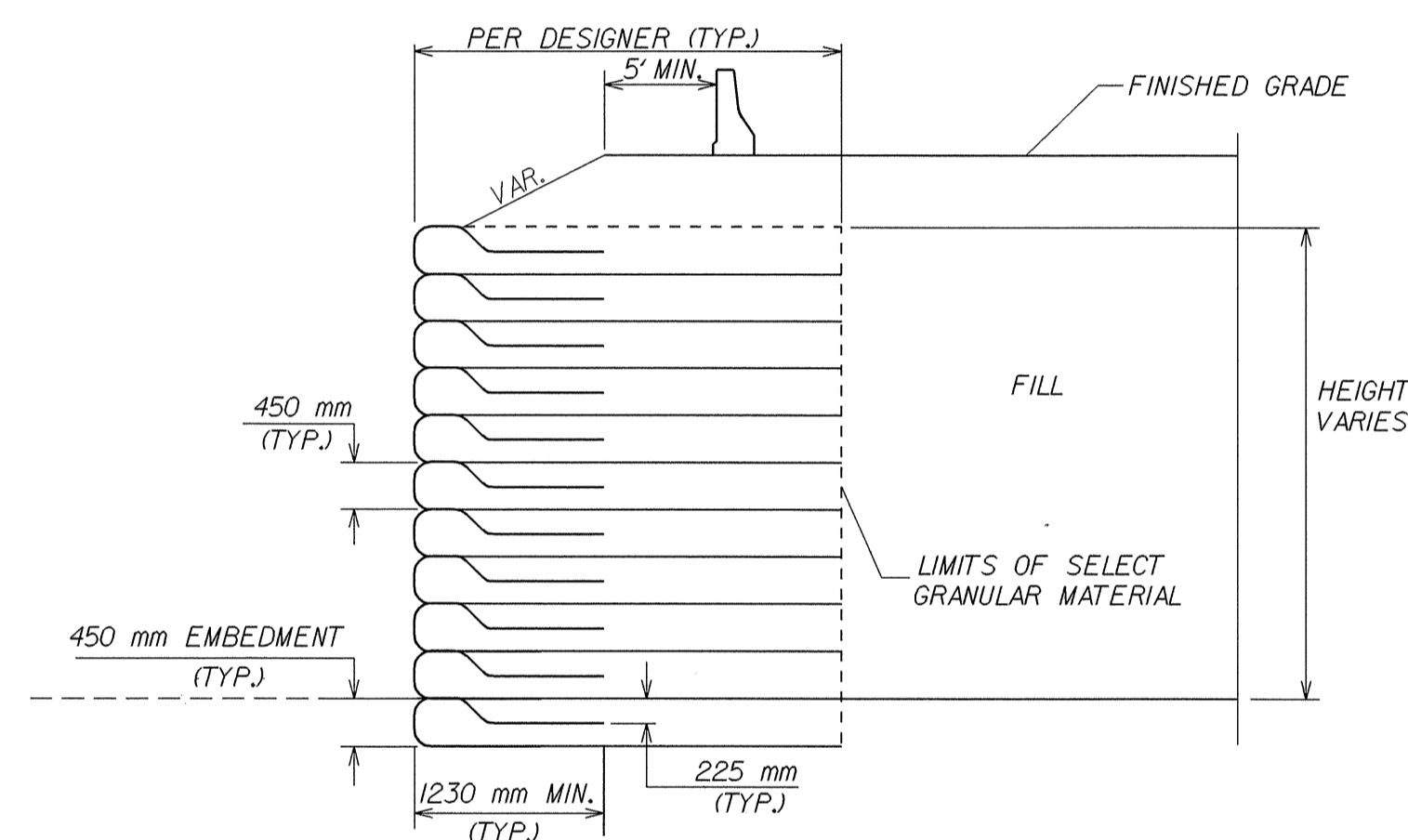

SECTION A-A
N.T.S.

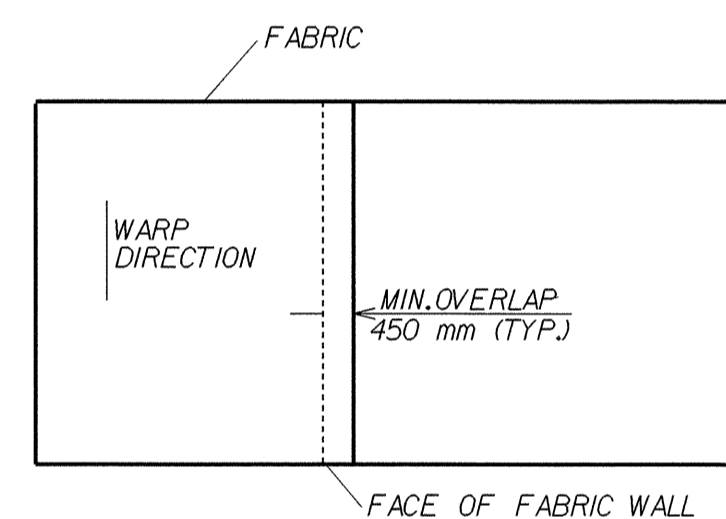

PLAN VIEW OF FABRIC OVERLAP
N.T.S.

NOTES:

- CONTRACTOR SHALL DESIGN TEMPORARY FABRIC WALL PER PLANS AND SPECIAL PROVISIONS AND SUBMIT TO THE ENGINEER FOR REVIEW AND APPROVAL
- REGARDLESS OF THE CONTRACTOR DESIGN, FABRIC FOR THE TEMPORARY FABRIC WALL SHALL HAVE A MINIMUM WIDE WIDTH TENSILE STRENGTH OF 27 kN/m IN THE WARP DIRECTION (BASED ON ASTM-D4595) AT 5% ELONGATION AND A MINIMUM ULTIMATE WIDE WIDTH TENSILE STRENGTH OF 65 kN/m IN THE WARP DIRECTION
- FOR TEMPORARY FABRIC WALL, SEE SPECIAL PROVISIONS.
- LOCATIONS AND QUANTITIES PROVIDED ARE ONLY APPROXIMATE. EXACT LOCATIONS AND QUANTITIES SHALL BE DETERMINED BY THE ENGINEER.
- THE FABRIC WALL SHALL BE BENCHED INTO THE SIDE OF THE EXCAVATION WHERE APPLICABLE AND AS DIRECTED BY THE ENGINEER.
- ALL EXCAVATION FOR THE CONSTRUCTION OF THE TEMPORARY FABRIC WALL WILL BE CONSIDERED INCIDENTAL TO THE COST OF THE WALL.
- PROPER DRAINAGE AT THE TOP OF THE WALL SHALL BE AS DIRECTED BY THE ENGINEER.
- SELECT GRANULAR MATERIAL SHALL BE CLASS II OR BETTER IN ACCORDANCE WITH SECTION 1016 OF THE STANDARD SPECIFICATIONS.
- THE CONTRACTOR MAY ELECT TO USE A FORMING SYSTEM TO CONSTRUCT THE TEMPORARY FABRIC WALL OTHER THAN THE FALSEWORK OR WIRE MESH FORM OPTIONS SHOWN IN THESE PLANS, HOWEVER, THE ALTERNATE METHOD MUST BE SUBMITTED TO THE ENGINEER FOR REVIEW AND APPROVAL.
- WHEN THE FINAL FILL IS PLACED IN FRONT OF THE WALL, UNFOLD THE TOP LAYER OF FABRIC AND INCORPORATE IT INTO THE FILL AS DIRECTED BY THE ENGINEER.
- THE ENGINEER WILL SCHEDULE A PRECONSTRUCTION CONFERENCE WITH REPRESENTATIVES FROM THE CONTRACTOR, THE WALL DESIGN, AND THE GEOTECHNICAL ENGINEERING UNIT TO DISCUSS THE DETAILS AND INSPECTION OF THE RETAINING WALL PRIOR TO ANY EXCAVATION OR WORK FOR THE WALL.

FORM OPTION #1

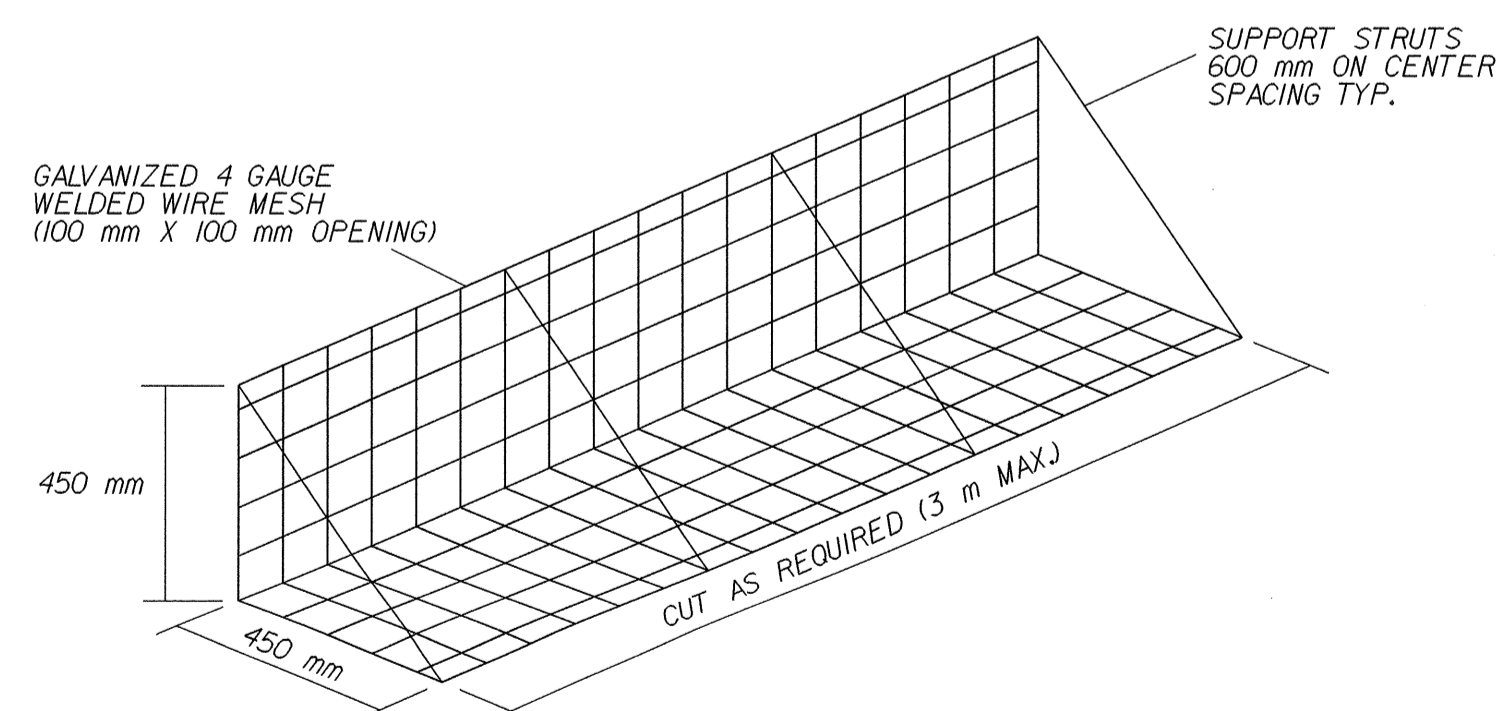

WELDED WIRE MESH FORM
N.T.S.

FORM OPTION #2

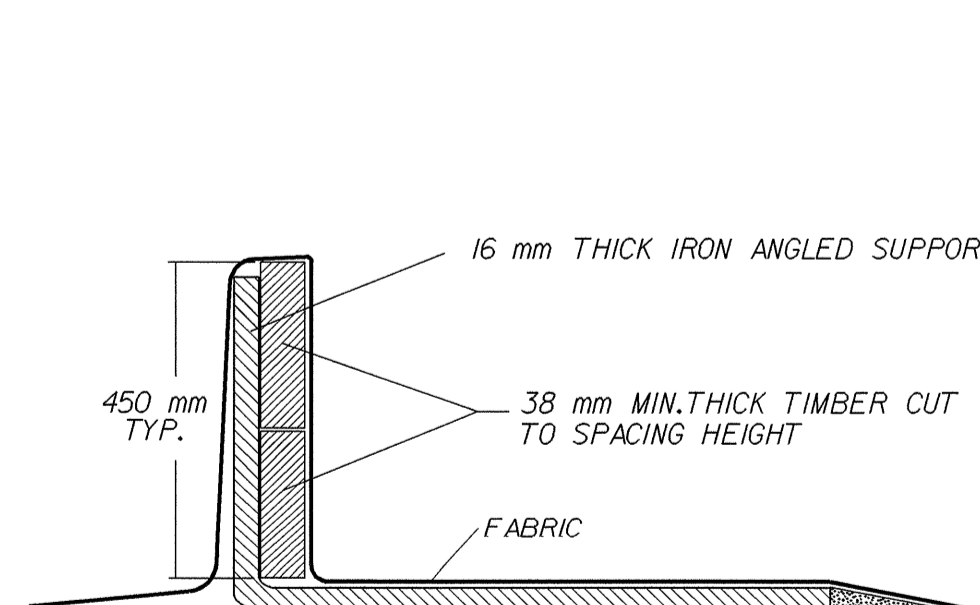

ELEVATION VIEW OF WALL FACE FALSEWORK
N.T.S.

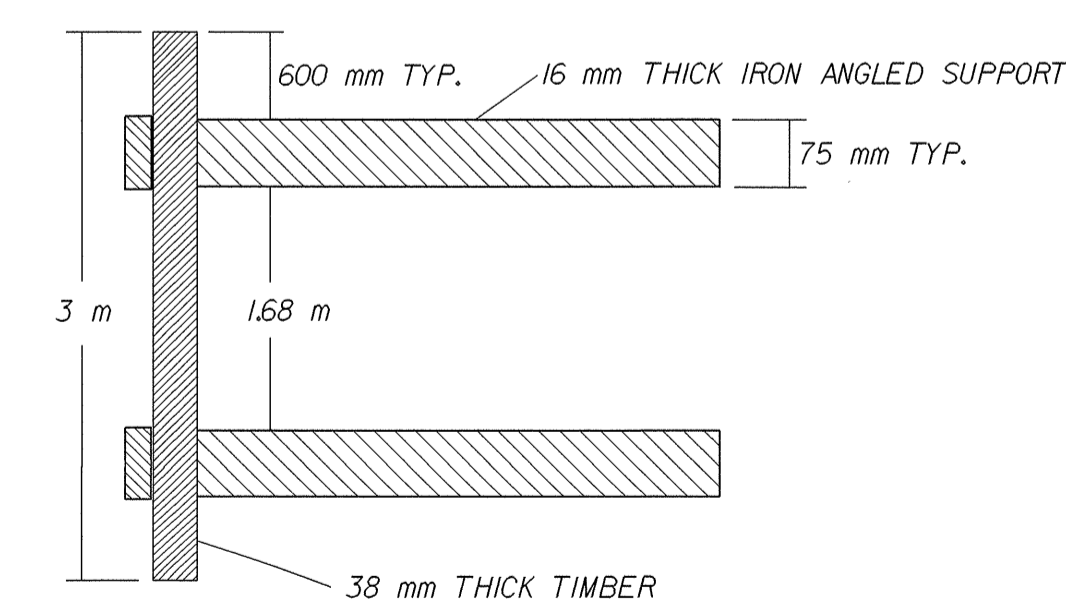

PLAN VIEW OF WALL FACE FALSEWORK
N.T.S.

PROJECT: R-2568B
DAVIDSON COUNTY
STATION: SEE TRAFFIC CONTROL PLANS

STATE OF NORTH CAROLINA
DEPARTMENT OF TRANSPORTATION
RALEIGH

DETAIL OF
TEMPORARY FABRIC WALL

DRAWN BY ML DATE 9-08-04
CHECKED BY MV DATE 9-8-04