

8/17/24
 REVISIONS
 MATCH TO SHEET NO. 14
 MATCH TO SHEET NO. 16
 OR-SEP-2004 08:28
 R:\PROJECTS\25688\15 RD212453
 M:\MICHAEL

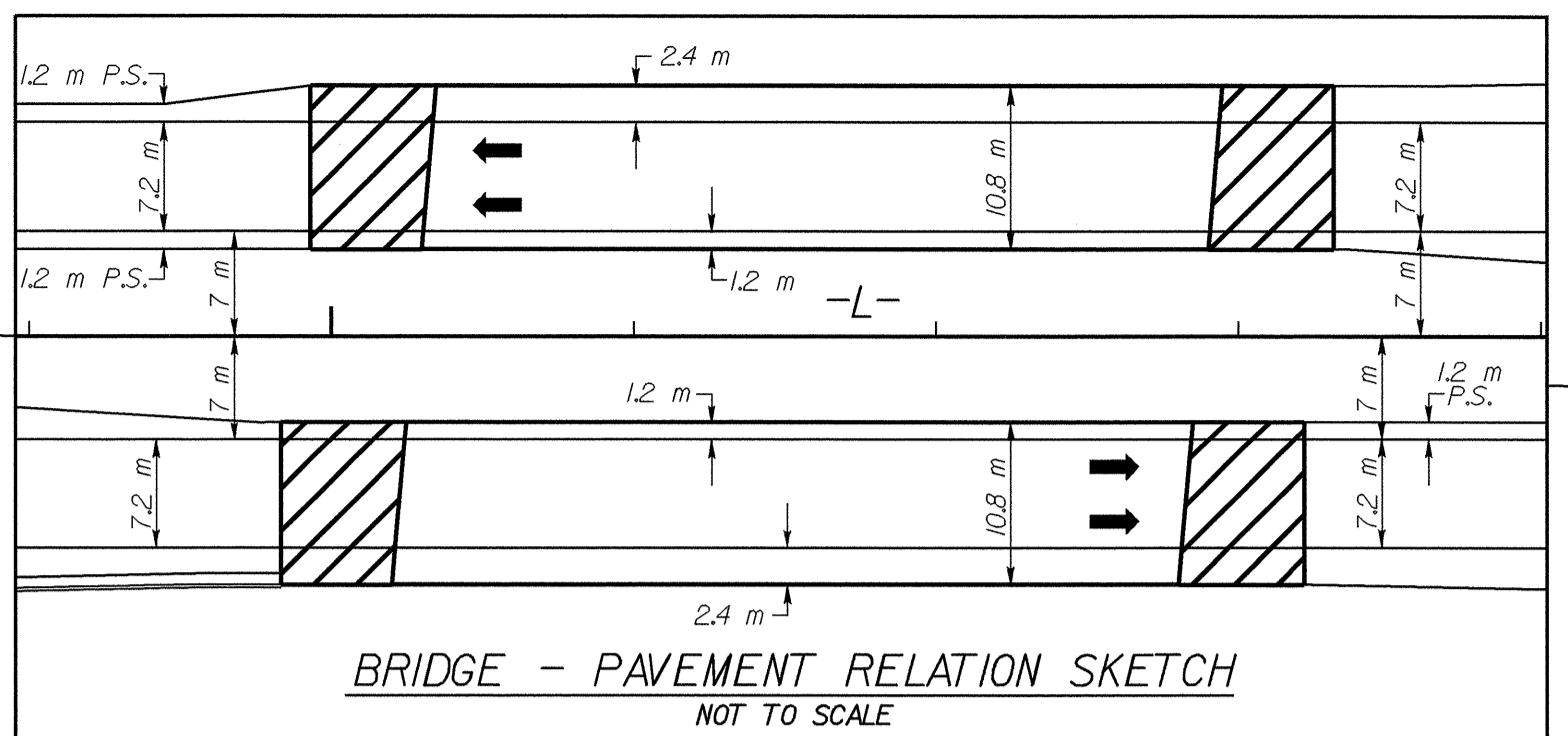

-L-
 PI Sta. 59+17.176
 $\Delta = 7^\circ 25' 17.7''$ (RT.)
 $L = 226.680$
 $T = 113.499$
 $R = 1,750.000$
 $S.E. = 0.03$
 RUNOFF = 54

-L-
 PIs Sta. 62+52.675
 $\Delta = 2^\circ 56' 47.9''$
 $L_s = 90.000$
 $LT = 60.008$
 $ST = 30.008$



PROJECT REFERENCE NO. R-25688		SHEET NO. 15	
R/W SHEET NO. 15		HYDRAULICS ENGINEER	
ROADWAY DESIGN ENGINEER		SEAL 22100	
CONST. REV.		SEAL 22557	
R/W REV.		MICHAEL W. MICHAEL	

9/8/24

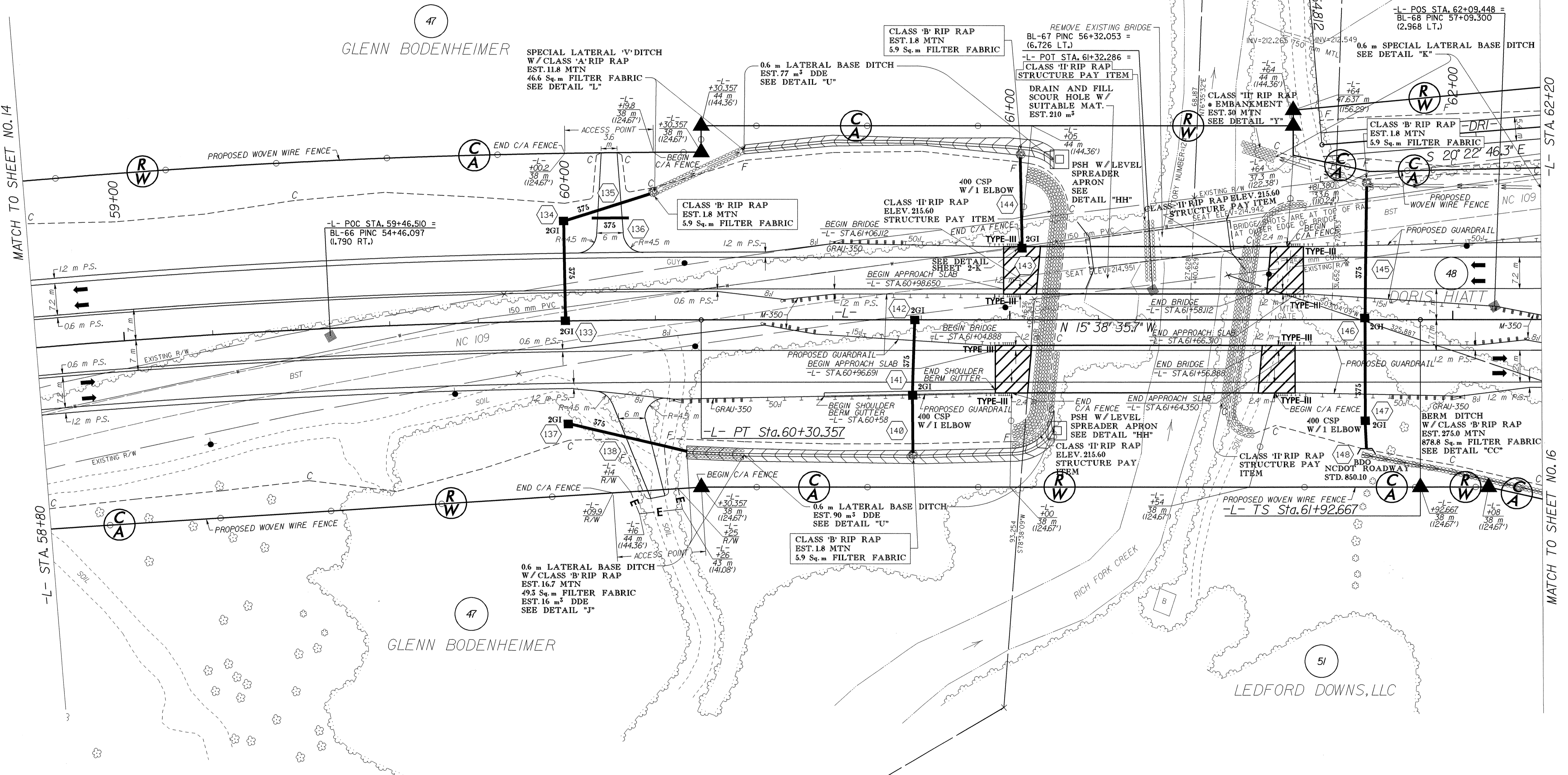

NOTES:
 (1) SEE SHEET 2-E FOR DRAINAGE DETAILS
 (2) SEE SHEET 33 FOR -L- PROFILE
 (3) SEE SHEET 44 FOR -DRI- PROFILE
 (4) SEE SHEETS S-1 TO S-64 FOR STRUCTURE DETAILS