

INCOMPLETE PLANS FOR R/W ACQUISITION
PRELIMINARY PLANS NOT TO BE USED FOR CONSTRUCTION

ENGINEER MICHAEL W. LITTLE

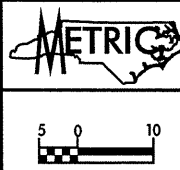

CONST. REV.
R/W REV.

BM #J3 - RR SPIKE IN 24" SWEET GUM
-BL- 36+91, 75.9 m RT.
EL. = 234.913

SOIL TEST RESULTS															
SAMPLE NO.	OFFSET	STATION	DEPTH INTERVAL	AASHTO CLASS.	L.L.	P.L.	% BY WEIGHT				% PASSING SIEVES			% MOISTURE	% ORGANIC
							C. SAND	F. SAND	SILT	CLAY	10	40	200		
SS-30	CL	46+00	1.02-1.47	A-4(1)	32	10	32.4	28.3	13.2	26.1	99	80	44	-	-
SS-31	CL	46+80	0.00-0.45	A-2-4(0)	27	NP	39.6	30.2	20.2	10.1	97	74	34	-	-
SS-32	27M LT	47+70	0.00-0.45	A-4(0)	24	NP	15.9	48.8	23.2	12.1	100	96	44	-	-
SS-33	CL	48+55	1.25-1.70	A-4(0)	22	4	38.6	25.1	16.2	20.1	96	71	39	-	-
SS-34	CL	48+55	2.77-3.22	A-1-b(0)	22	NP	65.5	20.3	6.1	8.0	80	39	14	-	-

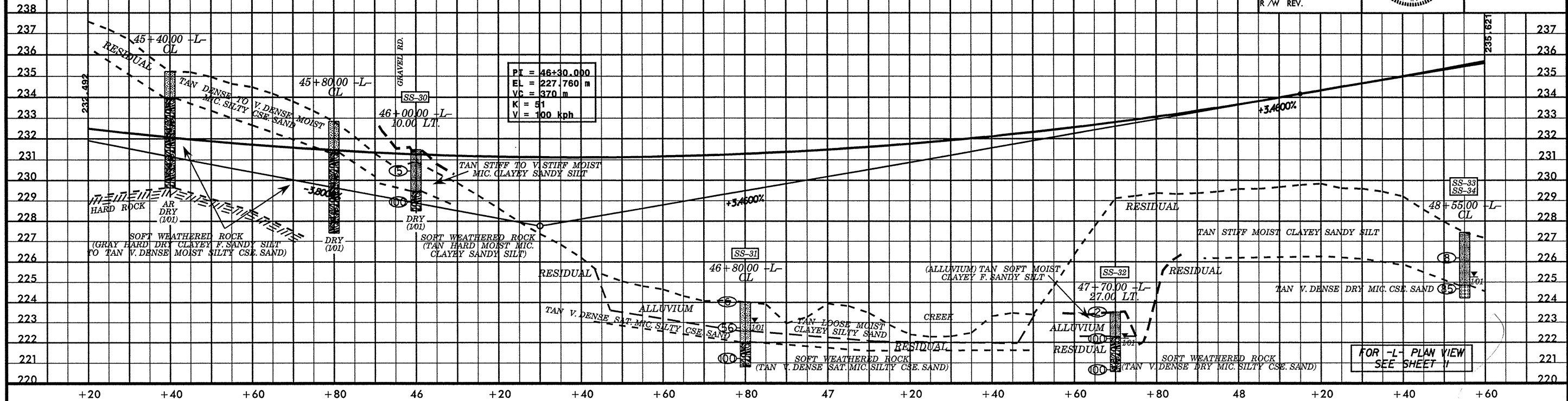

BM #J4 - RR SPIKE IN 20" SWEET GUM
-BL- 45+55, 102.7 m RT.
EL. = 242.360

SOIL TEST RESULTS															
SAMPLE NO.	OFFSET	STATION	DEPTH INTERVAL	AASHTO CLASS.	L.L.	P.L.	% BY WEIGHT				% PASSING SIEVES			% MOISTURE	% ORGANIC
							C. SAND	F. SAND	SILT	CLAY	10	40	200		
SS-35	20M RT	50+00	1.13-1.46	A-4(0)	21	NP	9.6	51.1	31.3	8.0	100	98	51	-	-
SS-36	20M RT	50+00	2.65-3.04	A-4(1)	33	NP	2.6	26.5	60.8	10.1	100	99	83	-	-
SS-37	10M RT	50+85	0.00-0.45	A-2-4(0)	22	NP	55.7	24.9	11.4	8.0	90	54	21	-	-
SS-38	10M RT	50+85	1.05-1.50	A-4(0)	21	3	24.1	27.3	28.4	20.1	97	82	53	-	-

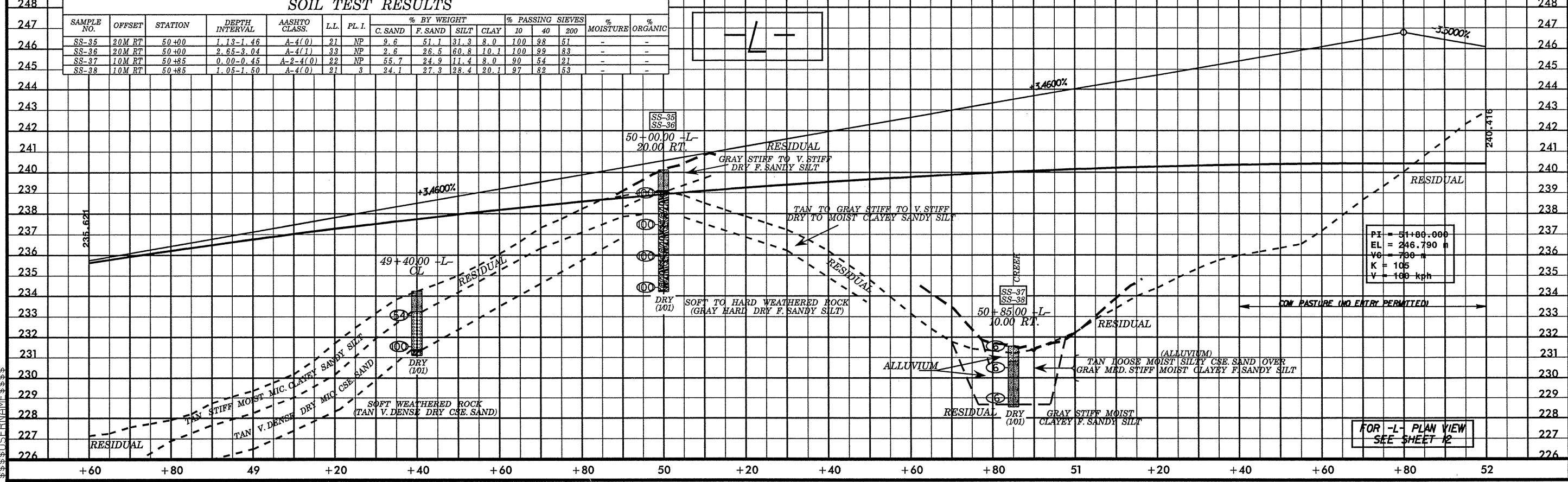

\$\$\$\$\$SYTIME\$\$\$\$\$
\$\$\$\$\$DGN\$\$\$\$\$
\$\$\$\$\$USERNAM\$\$\$\$\$