

FOR PLAN OF CONCRETE BARRIER RAIL
SEE "CONCRETE BARRIER RAIL" SHEET 1 OF 2.

① 1/2" EXP. JT. MAT'L HELD IN PLACE WITH GALVANIZED NAILS.
(NOTE: OMIT EXP. JT. MAT'L. WHEN SLIP FORM IS USED.)

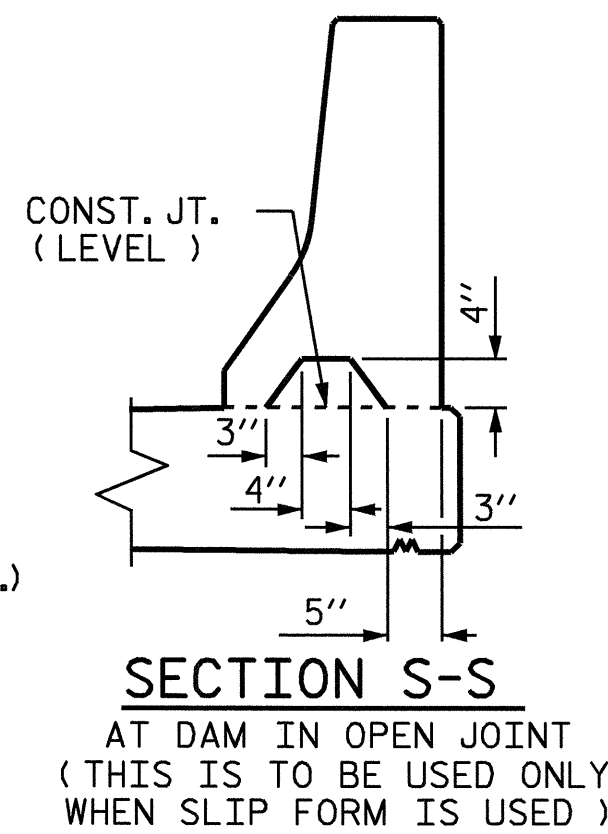

BARRIER RAIL DETAILS

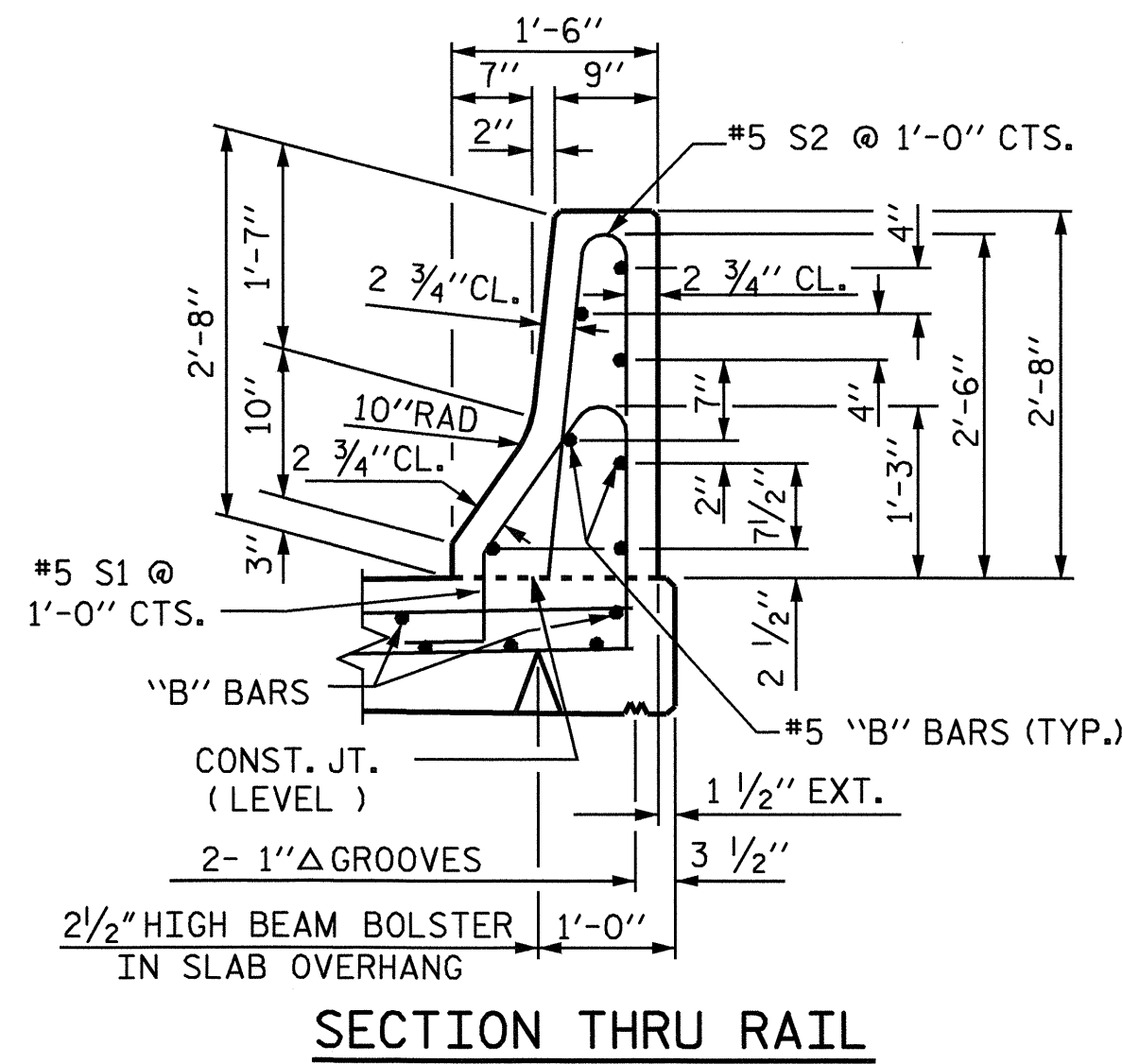
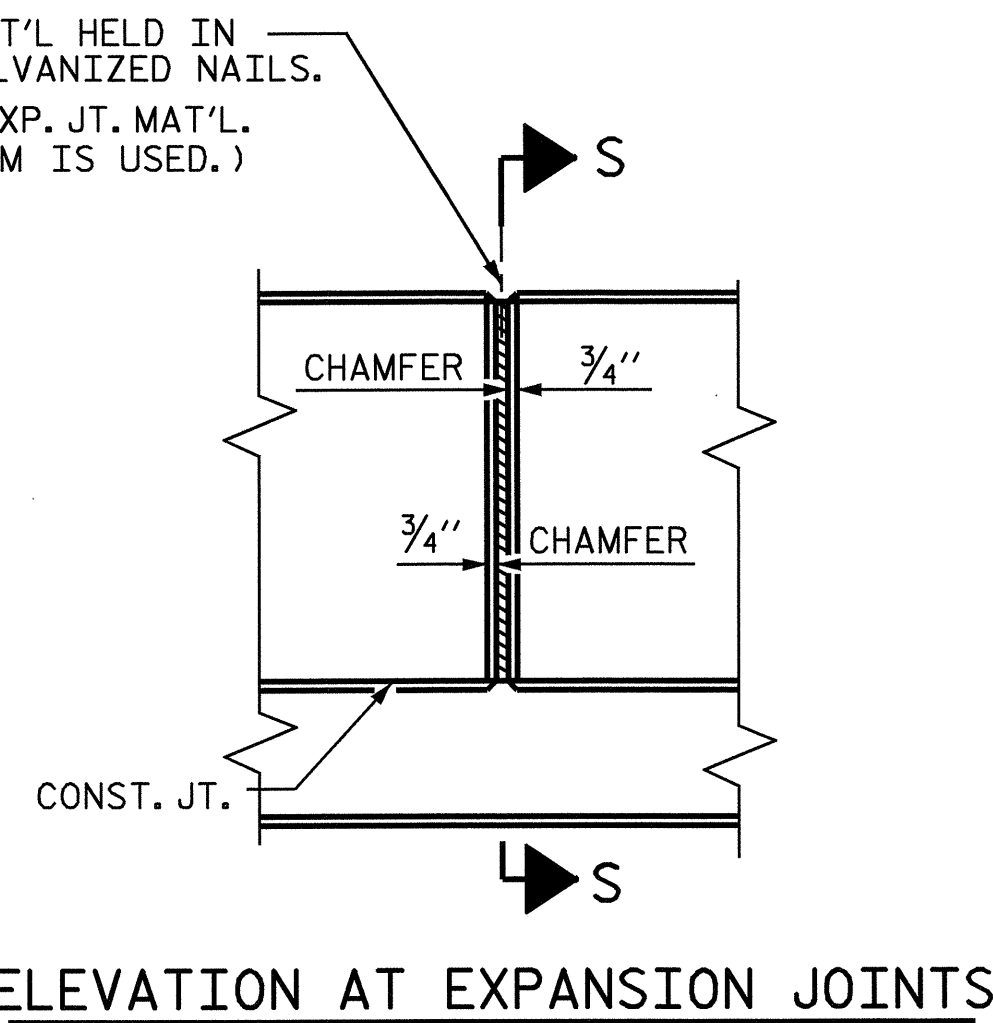
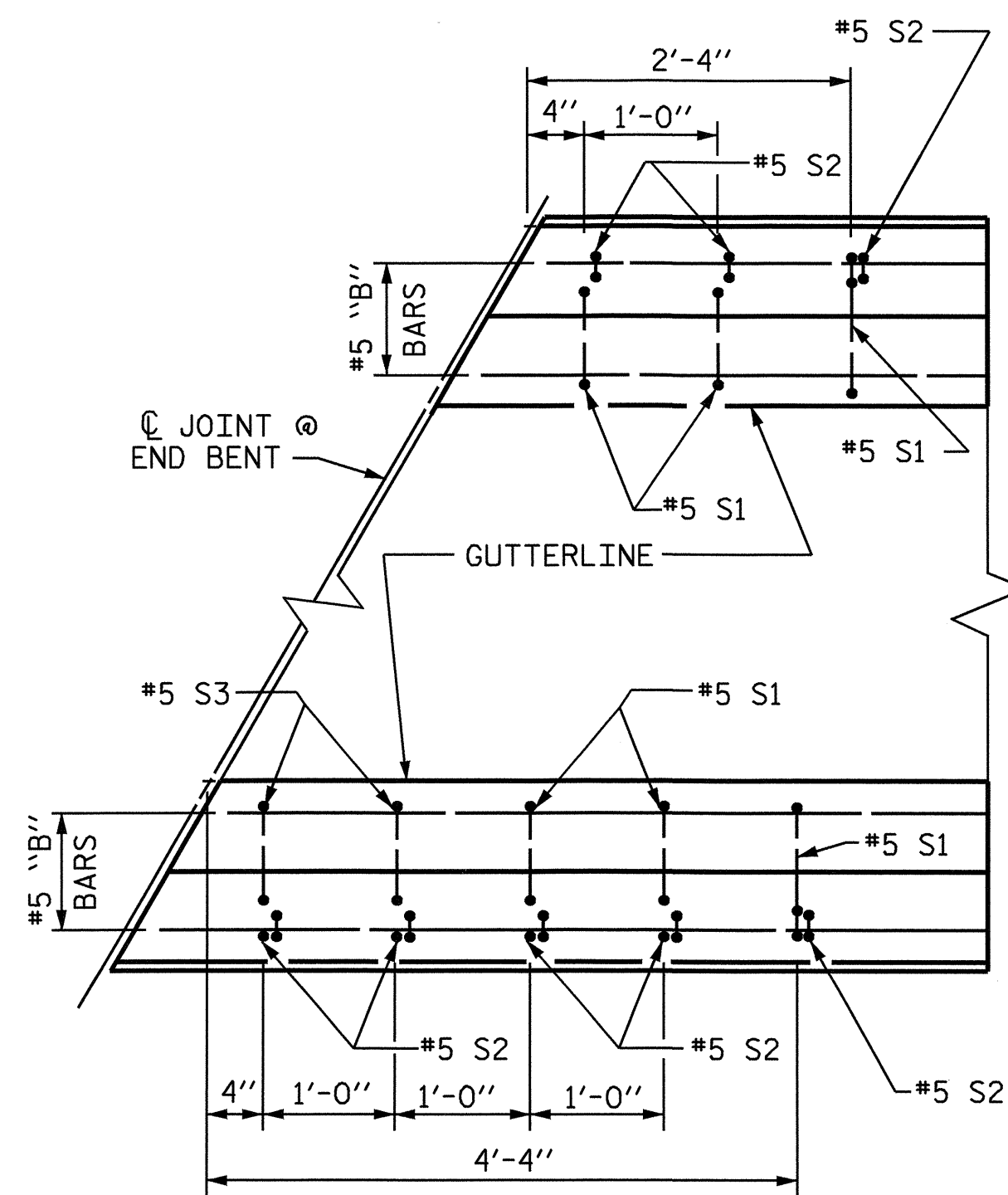

END OF RAIL DETAILS
FOR ADHESIVE ANCHORING AT SAWED JOINTS

NOTES

BARRIER RAIL IN A CONTINUOUS UNIT SHALL NOT BE CAST UNTIL ALL SLAB CONCRETE IN THE UNIT HAS BEEN CAST AND HAS REACHED A MINIMUM COMPRESSIVE STRENGTH OF 3,000 PSI.

ALL REINFORCING STEEL IN BARRIER RAILS SHALL BE EPOXY COATED.

VERTICAL GROOVED CONTRACTION JOINTS, 1/2" IN DEPTH, SHALL BE TOOLED IN ALL EXPOSED FACES OF THE BARRIER RAIL AND IN ACCORDANCE WITH ARTICLE 825-10(B) OF THE STANDARD SPECIFICATIONS. THE CONTRACTION JOINT SHALL BE LOCATED AT EACH THIRD POINT BETWEEN BARRIER RAIL EXPANSION JOINTS. ONLY ONE CONTRACTION JOINT IS REQUIRED AT MIDPOINT OF BARRIER RAIL SEGMENTS LESS THAN 20 FEET IN LENGTH AND NO CONTRACTION JOINTS ARE REQUIRED FOR THOSE SEGMENTS LESS THAN 10 FEET IN LENGTH.

BAR TYPES

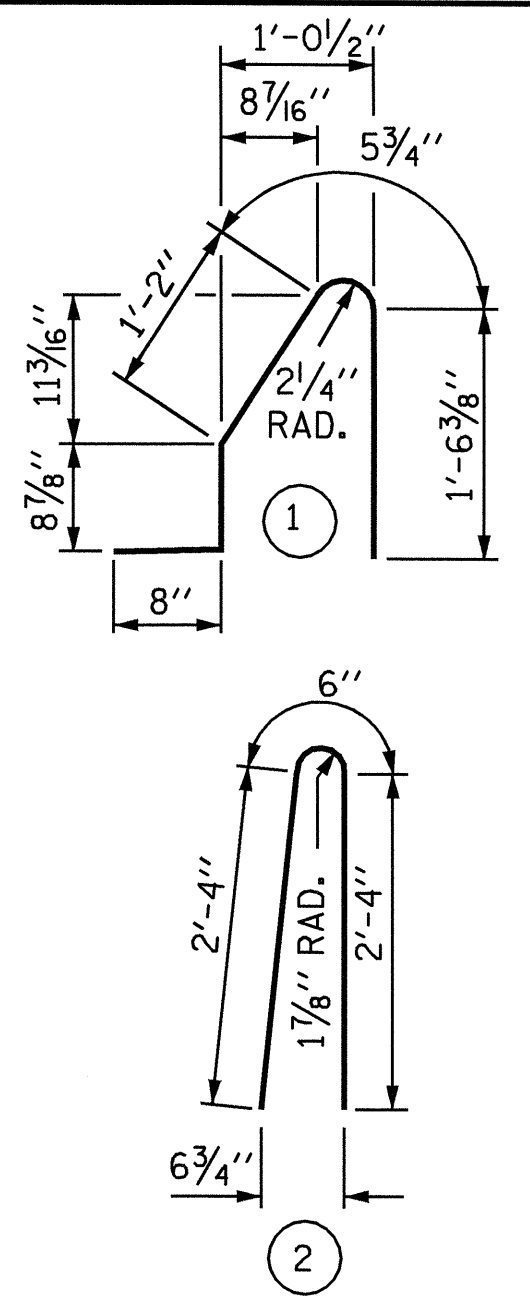

ALL BAR DIMENSIONS ARE OUT TO OUT

BILL OF MATERIAL

FOR CONCRETE BARRIER RAIL ONLY

BAR	NO.	SIZE	TYPE	LENGTH	WEIGHT
* B1	56	#5	STR	14'-10"	866
* B2	98	#5	STR	24'-7"	2513
* S1	454	#5	1	4'-7"	2170
* S2	454	#5	2	5'-2"	2447

* EPOXY COATED	
REINFORCING STEEL	7996 LBS.
CLASS AA CONCRETE	45.1 CU. YDS.
CONCRETE BARRIER RAIL	451.86 LIN. FT.

PROJECT NO. B-4096
DAVIDSON COUNTY
STATION: 20+38.40 -L-

SHEET 2 OF 2

STATE OF NORTH CAROLINA
DEPARTMENT OF TRANSPORTATION
RALEIGH
STANDARD
CONCRETE
BARRIER RAIL

OCTOBER 1987

REVISIONS			SHEET NO.		
NO.	BY:	DATE:	NO.	BY:	DATE:
1			3		
2			4		
					TOTAL SHEETS
					33

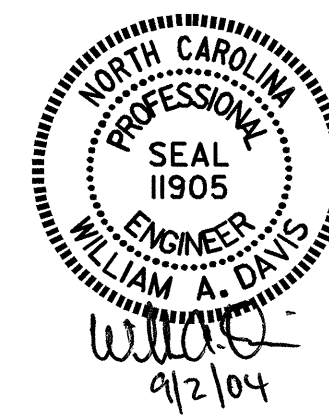

ASSEMBLED BY :	J. G. KHARVA	DATE :	03/20/04
CHECKED BY :	J. D. HAWK	DATE :	04/01/04
DRAWN BY :	ARB 5/87	REV. 8/16/99	RWW/LES
CHECKED BY :	SJD 9/87	REV. 10/17/00	RWW/LES
		REV. 5/7/03R	RWW/JTE