

UTILITY CONSTRUCTION

<p>-L-</p> <p>Pls Sta 265+16.448 $\Delta = 3^\circ 34' 27.3''$ (LT) $\theta_s = 0^\circ 59' 41.0''$ $L_s = 125,000$ $L = 224,576$ $L_s = 125,000$ $LT = 83,335$ $T = 112,325$ $LT = 83,335$ $ST = 41,668$ $R = 3,600,000$ $ST = 41,668$ $SE = 2.5\%$</p>			<p>-Y5-</p> <p>Pls Sta 20+71.318 $\Delta = 30^\circ 22' 20.9''$ (RT) $\theta_s = 6^\circ 36' 39.8''$ $L_s = 60,000$ $L = 137,826$ $L_s = 60,000$ $LT = 40,028$ $T = 70,573$ $LT = 40,028$ $ST = 20,025$ $R = 260,000$ $ST = 20,025$ $SE = 8\%$</p>		
<p>RAMP "B"</p> <p>Pls Sta 0+60.052 $\Delta = 33^\circ 03' 00.2''$ (LT) $\theta_s = 7^\circ 21' 59.8''$ $L_s = 90,000$ $L = 201,891$ $L_s = 60,000$ $LT = 60,052$ $T = 103,841$ $LT = 40,015$ $ST = 30,047$ $R = 350,000$ $ST = 20,014$ $SE = 7\%$</p>		<p>RAMP "C"</p> <p>Pls Sta 1+40.083 $\Delta = 113^\circ 30' 37.1''$ (RT) $\theta_s = 10^\circ 58' 17.5''$ $L_s = 90,000$ $L = 465,565$ $L_s = 90,000$ $LT = 60,116$ $T = 358,505$ $LT = 30,105$ $ST = 30,105$ $R = 235,000$ $ST = 32,150$ $SE = 8\%$</p>		<p>Pls Sta 22+49.141 $\theta_s = 6^\circ 36' 39.8''$ $L_s = 60,000$ $LT = 40,028$ $ST = 20,025$</p>	

SEE SHEET NO. 55 FOR LINE -L- RT LN TRANS GRADE AND PROFILE.
 SEE SHEET NO. 55 FOR LINE -L- LT LN TRANS GRADE AND PROFILE.
 SEE SHEET NO. 55 FOR LINE -L- GRADE AND PROFILE.
 SEE SHEET NO. 79 FOR RAMP B GRADE AND PROFILE.
 SEE SHEET NO. 81 FOR RAMP C GRADE AND PROFILE.
 SEE SHEET NO. 120 FOR LINE -Y5- GRADE AND PROFILE.

-L- LN TRANS

Pls Sta 264+80.007 $\theta_s = 0^\circ 59' 41.0''$ $L_s = 125,000$ $LT = 83,335$ $ST = 41,668$	Pls Sta 266+33.998 $\Delta = 3^\circ 34' 27.3''$ (LT) $\theta_s = 0^\circ 59' 41.0''$ $L_s = 125,000$ $LT = 83,335$ $ST = 41,668$	Pls Sta 267+46.250 $\theta_s = 0^\circ 59' 41.0''$ $L_s = 125,000$ $LT = 83,335$ $ST = 41,668$
---	--	---

-L- RT LN TRANS

Pls Sta 265+52.888 $\theta_s = 0^\circ 59' 41.0''$ $L_s = 125,000$ $LT = 83,335$ $ST = 41,668$	Pls Sta 267+06.878 $\Delta = 3^\circ 34' 27.3''$ (LT) $\theta_s = 0^\circ 59' 41.0''$ $L_s = 125,000$ $LT = 83,335$ $ST = 41,668$	Pls Sta 268+60.798 $\theta_s = 0^\circ 59' 41.0''$ $L_s = 125,000$ $LT = 83,335$ $ST = 41,668$
---	--	---

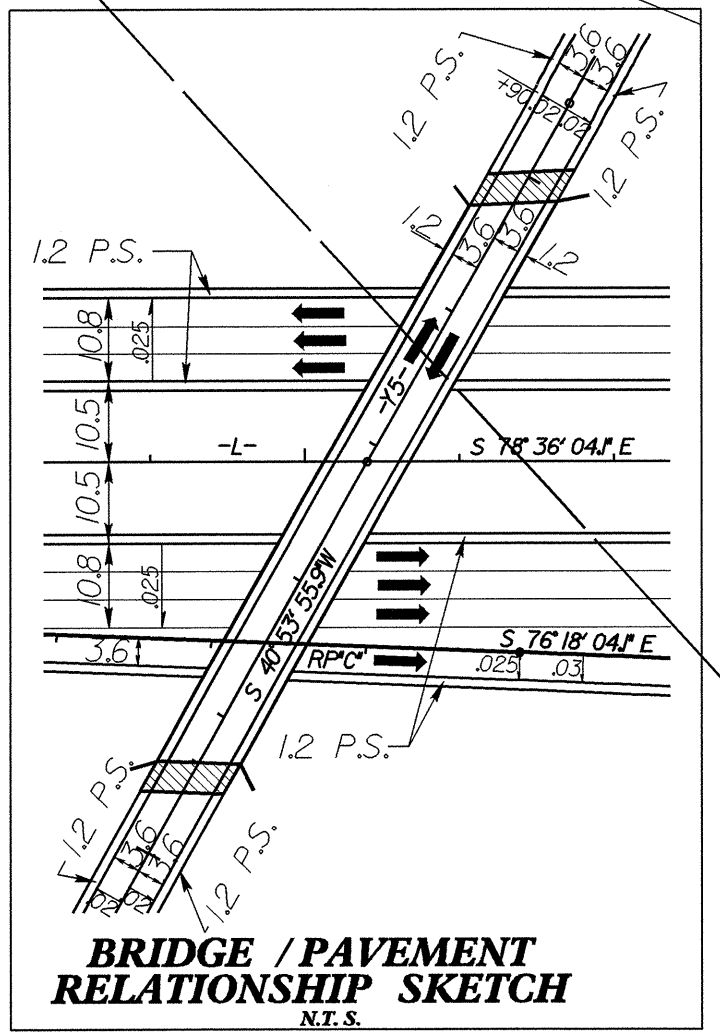

SEE SHEETS S THROUGH S FOR STRUCTURES PLANS

PROP. 248M-200MM PVC WATER PIPE, SDR 21, 1.38 MPA WP

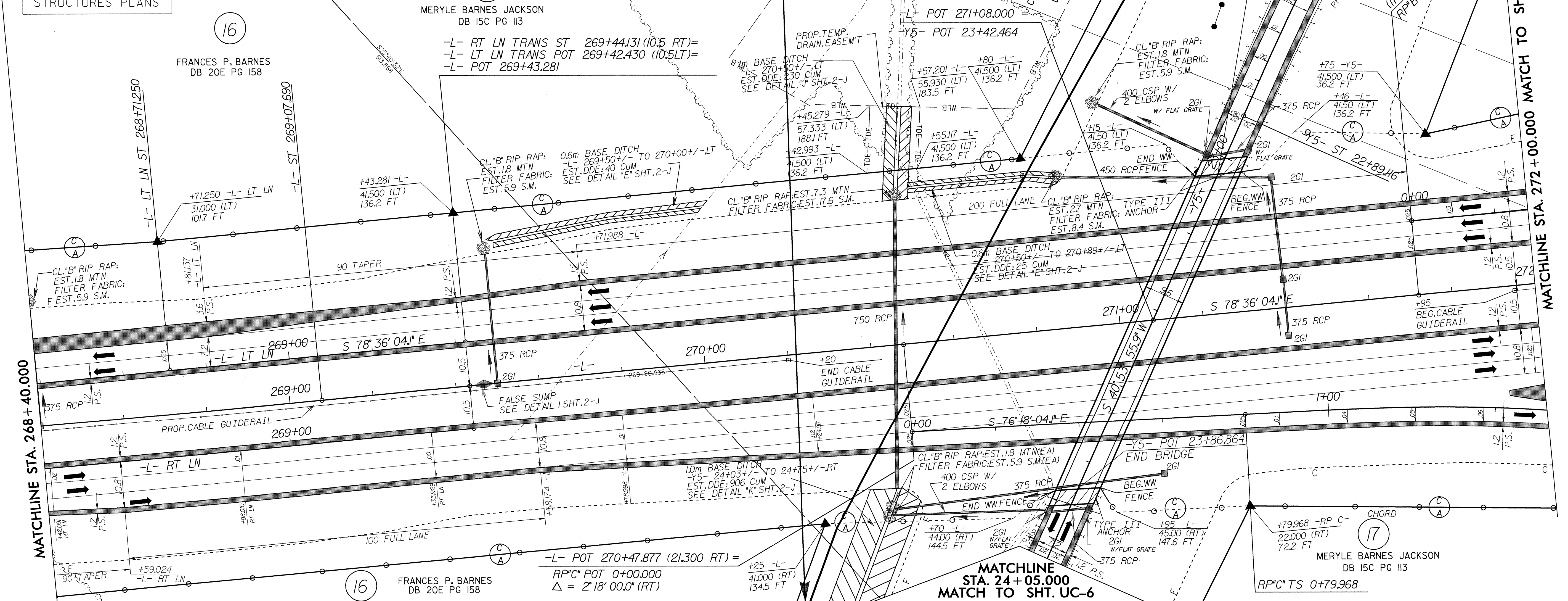

24-FEB-2004 11:56 AM
 R:\Utilities\Projects\7151309.FSH
 59524028 AT DSE14855