

-Y5-  
 PI Sta 11+97.741  
 $\Delta = 15^\circ 38' 36.8''$  (RT)  
 $L = 191.22$   
 $T = 96.159$   
 $R = 700.000$   
 $SE = 0.063$   
 RUNOFF = 51m

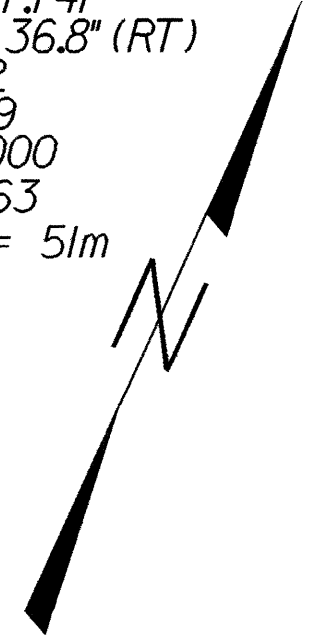

**NOTE:**  
 PLACE TEMPORARY ROCK SEDIMENT DAMS TYPE- B  
 AND TEMPORARY ROCK SILT CHECKS TYPE-A AT  
 DRAINAGE OUTLETS.

PROJECT REFERENCE NO. R-513 BB		SHEET NO. EC-27/CONST.28	
R/W SHEET NO.			
ROADWAY DESIGN ENGINEER		HYDRAULICS ENGINEER	
CONST.REV.		R/W REV.	

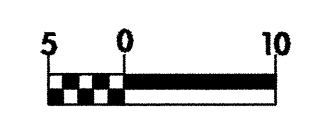

SEE SHEET 45 FOR -Y5- PROFILE

**CLEARING AND GRUBBING  
 EROSION CONTROL FOR  
 CONSTRUCTION SHEET 28**

18  
 JERRY FRANKLIN STONE  
 DB 595 PG 855

33  
 JUDY R. SMITH  
 DB 579 PG 637

20  
 E.W. STONE  
 DB 893 PG 656

