

-Y5-
 PI Sta. 11+97.741
 $\Delta = 15^\circ 38' 36.8''$ (RT)
 $L = 191.22$
 $T = 96.159$
 $R = 700.000$
 $SE = 0.063$
 RUNOFF = 51m

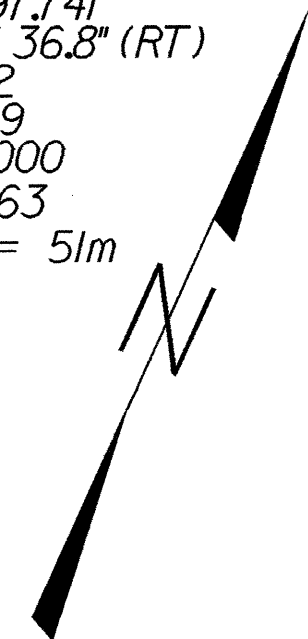

METRIC

CONST. REV.
 R/W REV.

PROJECT REFERENCE NO. R-513 BB	SHEET NO. EC-56/CONST.28
R/W SHEET NO.	
ROADWAY DESIGN ENGINEER	HYDRAULICS ENGINEER

SEE SHEET 45 FOR -Y5- PROFILE

18

JERRY FRANKLIN STONE
 DB 595 PG 855

33

JUDY R. SMITH
 DB 579 PG 637

10+00

11+00

8 x 2 x 1
 2 weir

8 x 2 x 1

-Y5- +45.000
 39.643
 (130.06 ft)

-Y5- +00.000
 30.956m
 (101.56 ft)

BEG C/A &
 WW FENCE
 -Y5- +05.338
 EX. R/W & 20.000m
 (65.62 ft)

-Y5- +80.000
 20.000m
 (65.62 ft)

SPECIAL LATERAL BASE DITCH
 (SEE DET. "T2")

N 65° 01' 14.5" E

N 65° 01' 14.5" E

S 73° 26' 23.5" W

-Y5- +02.052
 EX. R/W & 20.000m
 (65.62 ft)
 BEG C/A &
 WW FENCE

26 m TAPER
 BOTH SIDES

-Y5- +80.000
 20.000m
 (65.62 ft)

SPECIAL CUT BASE DITCH
 (SEE DET. "T1")

SPECIAL LATERAL BASE DITCH
 (SEE DET. "T2")

-Y5- +00.000
 30.956m
 (101.56 ft)

-Y5- 9+24.000
 BEG. CONST.
 BEG. 1.2m PS
 BOTH SIDES

6 x 2 x 1

8 x 2 x 1
 2 weir

12+00

E.W. STONE
 DB 893 PG 656

20

MATCHLINE -Y5- STA 12+00.000

