

	PROJECT REFERENCE NO.	SHEET NO.
	R-2514A	UC-13
DESIGNED BY: <b>ARK</b> DRAWN BY: <b>ARK</b> CHECKED BY: <b>GYS</b> APPROVED BY: <b>GYS</b> REVISED:		
NORTH CAROLINA PROFESSIONAL SEAL 023948 11-4-03 ENGINEER GREG Y. STEVENS		
NORTH CAROLINA DEPARTMENT OF TRANSPORTATION DESIGN SERVICES UNIT PHONE: (919) 250-4128 FAX: (919) 250-4119		
UTILITY CONSTRUCTION PLANS ONLY		

**UTILITY CONSTRUCTION**

**PROP. 41M OF 250MM HDPE WATER PIPE BY DIRECTIONAL BORE**

**PROP. 10.7M OF 200MM PVC WATER LINE SDR 21, 1.38 MPA WP**

**4-200MM 22 1/2° DI BEND**

**SEE SHEET UC-17 FOR PROFILE**

**MAKE CONNECTION USING THE NECESSARY FITTINGS**

0m BASE CHANNEL  
 15m ALONG EXISTING SLOPE  
 E CHANNEL IMPROVEMENT  
 TAIL "P"  
 T DDE = -35 M<sup>3</sup>

CLASS 1 RIPRAP  
 EST. 50 METRIC TONS  
 FOR 8m W/ F-F  
 EACH BANK

REMOVE EXISTING  
 (2) 3.08(W) x 1.22(H)  
 PROPOSED (2) 2.1(W)  
 x 1.81(H) RCBC

CLASS 'B' RIPRAP  
 EST. 0.9 TONS  
 FILTER FABRIC  
 EST. 4.2 SM

CLASS 'B' RIPRAP  
 EST. 3.1 TONS  
 FILTER FABRIC EST. 6.46 SM  
 PSRM EST. 17.68 SM

4.40m BASE CHANNEL  
 15m ALONG EXISTING SLOPE  
 SEE CHANNEL IMPROVEMENT  
 DETAIL "O"  
 EST DDE = 18 M<sup>3</sup>

-L MED-  
 PI Sta 161+44.003  
 $\Delta = 1^{\circ} 03' 51''$  (RT)  
 L = 64.915  
 T = 32.459  
 R = 3,495.000  
 SE = NC

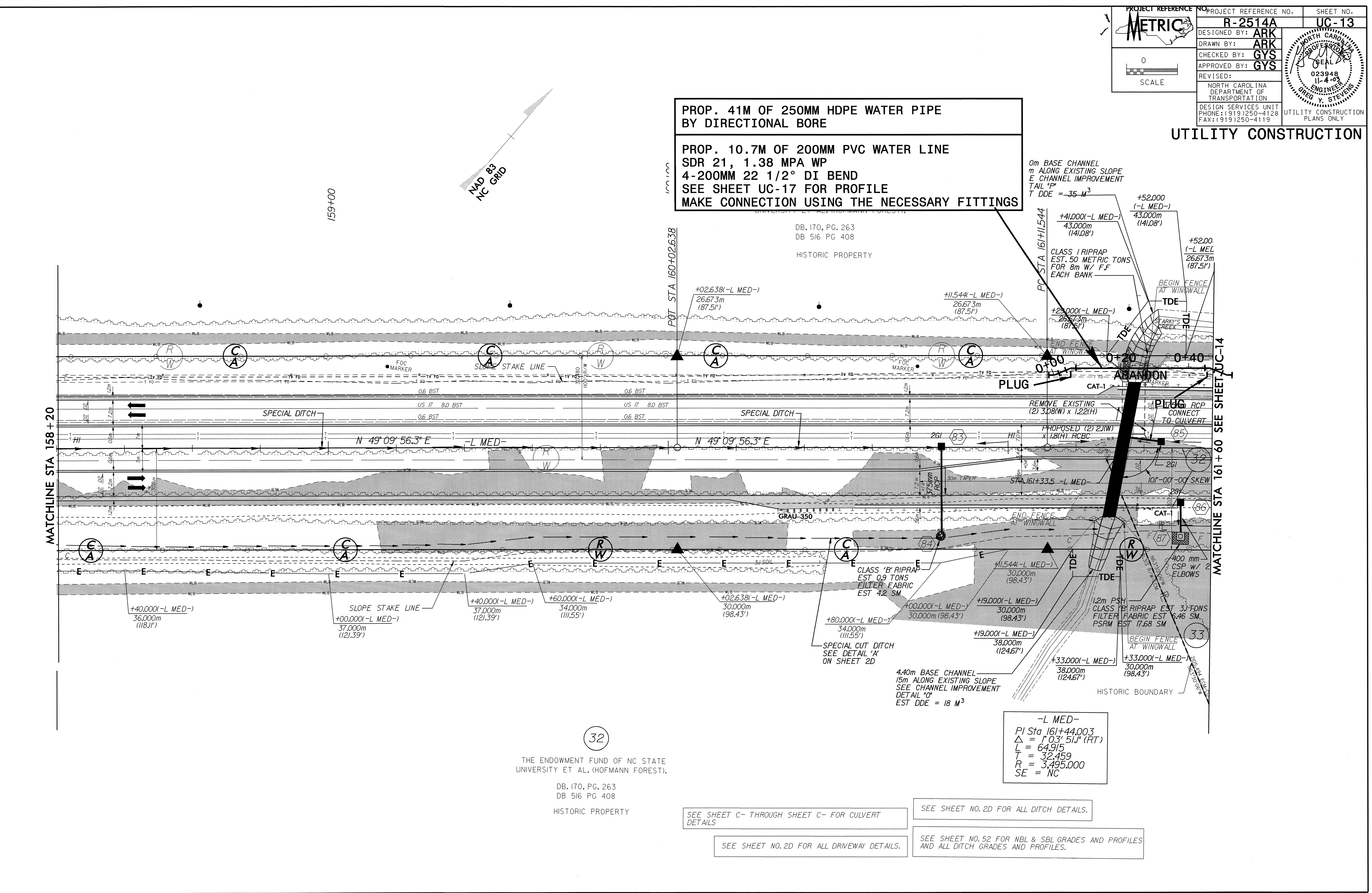

32

THE ENDOWMENT FUND OF NC STATE UNIVERSITY ET AL. (HOFMANN FOREST).  
 DB. 170, PG. 263  
 DB 516 PG 408  
 HISTORIC PROPERTY

SEE SHEET C- THROUGH SHEET C- FOR CULVERT DETAILS

SEE SHEET NO. 2D FOR ALL DITCH DETAILS.

SEE SHEET NO. 2D FOR ALL DRIVEWAY DETAILS.

SEE SHEET NO. 52 FOR NBL & SBL GRADES AND PROFILES AND ALL DITCH GRADES AND PROFILES.

04-NOV-2003 08:20  
 R:\Utility\2003\2514A\RDY\_PSH\_22-UC\_13.dgn  
 G:\WORK\2514A\11-4-03\11-4-03.dgn