

CONTRACT: C200827 TIP PROJECT: B-3470

See Sheet 1-A For Index of Sheets

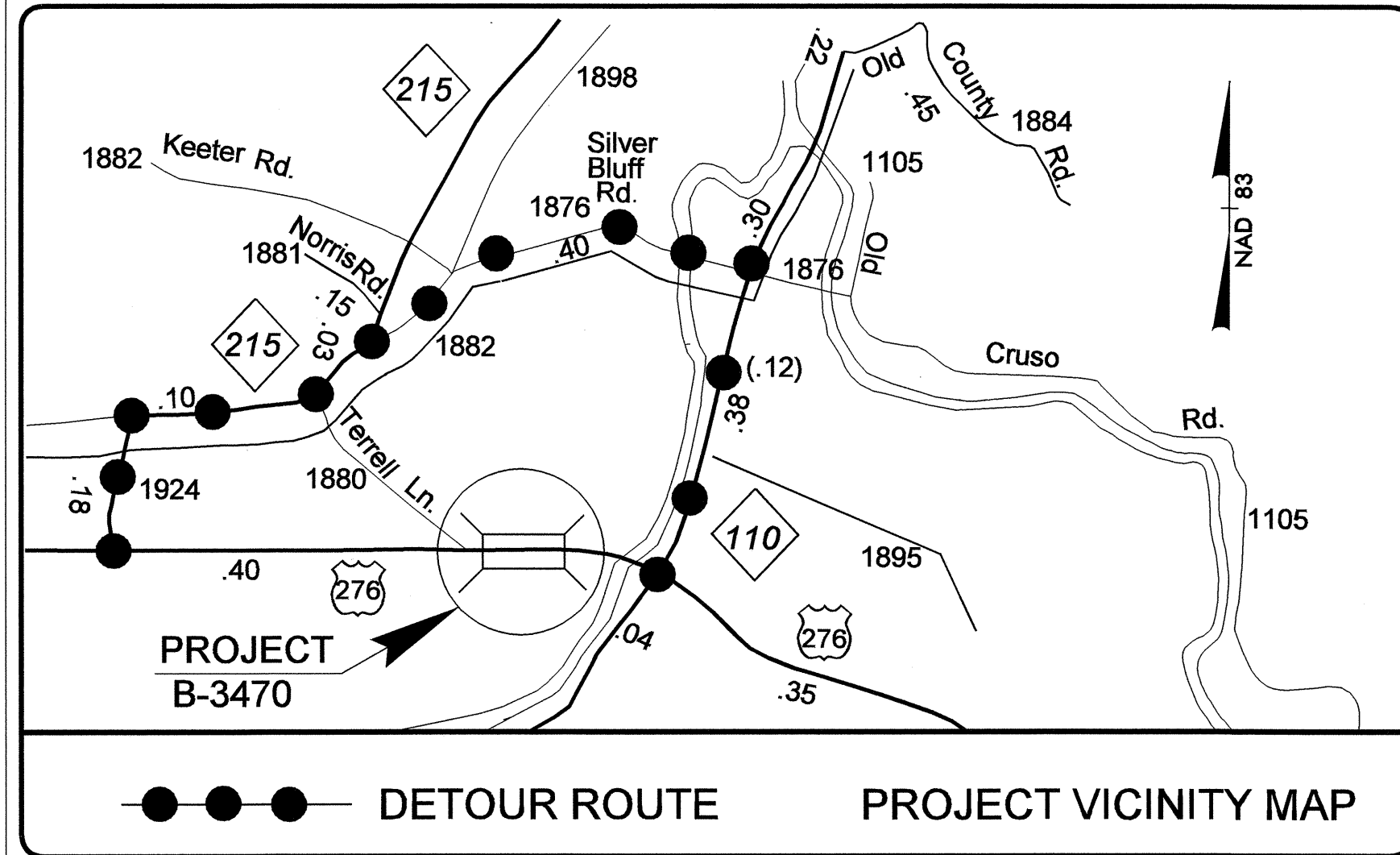

STATE OF NORTH CAROLINA
DIVISION OF HIGHWAYS

HAYWOOD COUNTY

**LOCATION: BRIDGE NO. 163 OVER PIGEON RIVER
OVERFLOW ON US 276**

TYPE OF WORK: GRADING, PAVING, DRAINAGE, AND STRUCTURE

STATE	STATE PROJECT REFERENCE NO.	SHEET NO.	TOTAL SHEETS
N.C.	B-3470	1	
STATE PROJ. NO.	F.A. PROJ. NO.	DESCRIPTION	
33088.1.1	BRSTP-276(2)	P.E., PE FOR FOR UTILITIES	
33088.2.2	BRSTP-276(2)	RW & UTIL	
33088.3.2	BRSTP-276(6)	CONST.	

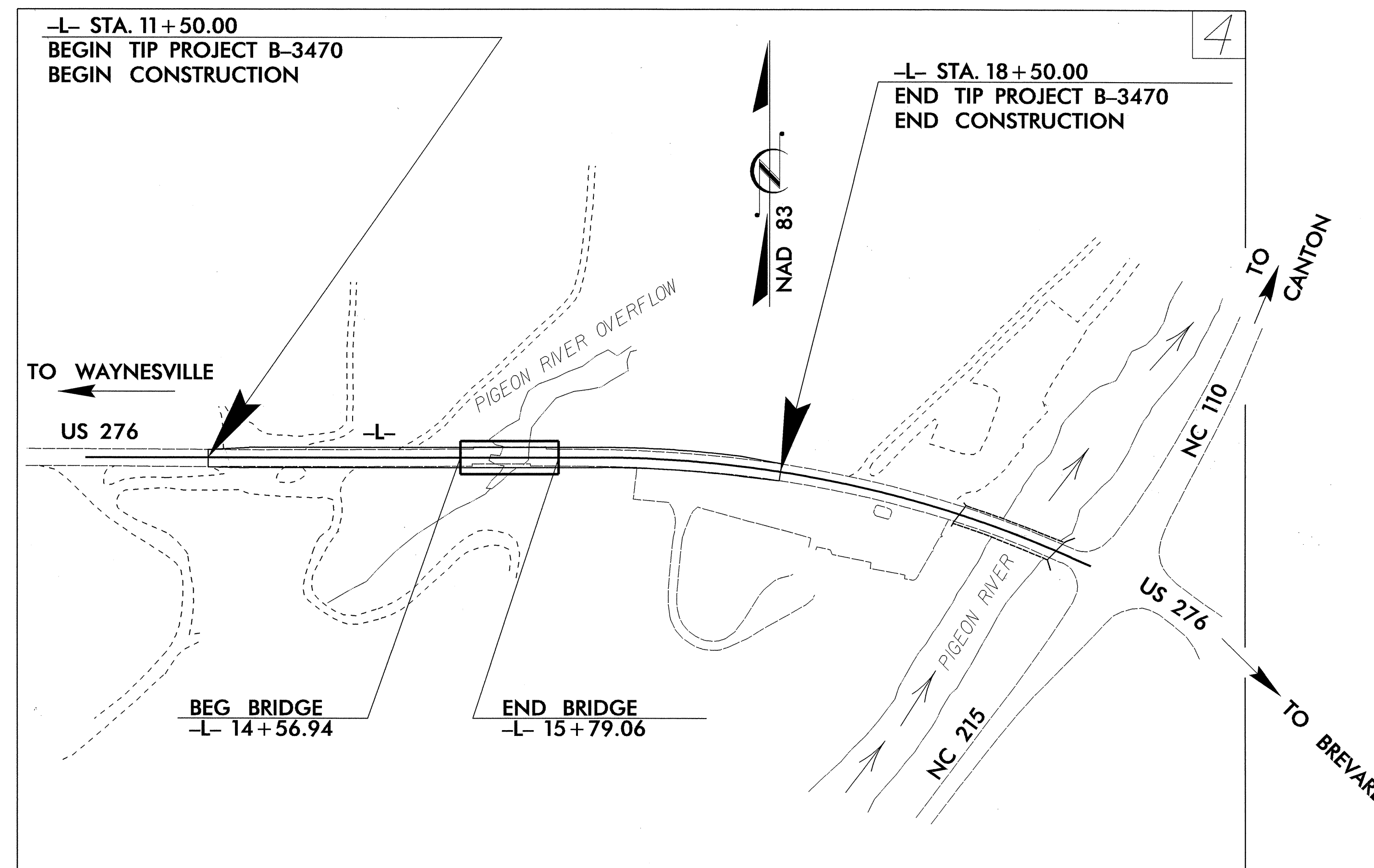

GRAPHIC SCALES

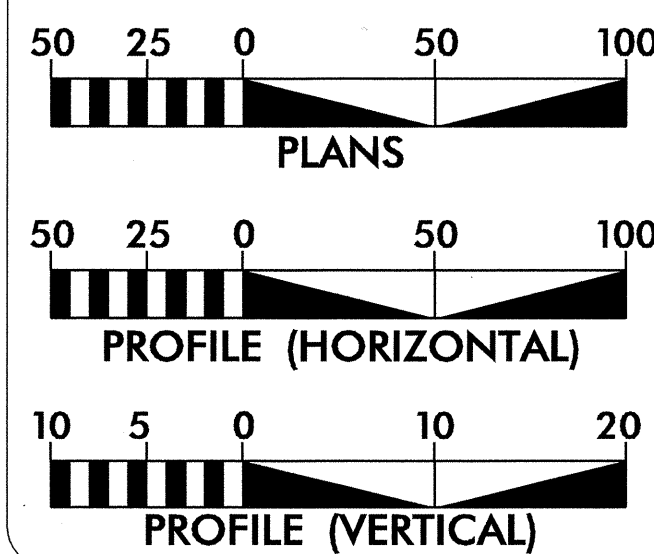

DESIGN DATA

ADT 2004 = 6865
ADT 2024 = 10327
DHV = 9 %
D = 55 %
T = 5 % *
V = 50 MPH
* TTST 1% DUAL 4%

PROJECT LENGTH

LENGTH ROADWAY TIP PROJECT B-3470 = 0.110 MILES
LENGTH STRUCTURE TIP PROJECT B-3470 = 0.023 MILES
TOTAL LENGTH TIP PROJECT B-3470 = 0.133 MILES

Prepared in the Office of:

DIVISION OF HIGHWAYS
1000 Birch Ridge Dr., NC, 27610

2002 STANDARD SPECIFICATIONS

RIGHT OF WAY DATE:
February 27, 2003

LETTING DATE:
OCTOBER 19, 2004

GARY LOVERING, P.E.
PROJECT ENGINEER

R. A. SHILLINGLAW, P.E.
PROJECT DESIGN ENGINEER

HYDRAULICS ENGINEER

PROFESSIONAL SEAL
22100
STEPHEN R. MORGAN
5/21/04
SIGNATURE: Stephen R. Morgan, P.E.

ROADWAY DESIGN ENGINEER
PROFESSIONAL SEAL
17691
RICHARD A. SHILLINGLAW
05-21-04
SIGNATURE: Richard A. Shillinglaw, P.E.

DIVISION OF HIGHWAYS
STATE OF NORTH CAROLINA

ant millan
P.E.

STATE DESIGN ENGINEER
DEPARTMENT OF TRANSPORTATION
FEDERAL HIGHWAY ADMINISTRATION

APPROVED
DIVISION ADMINISTRATOR
DATE