

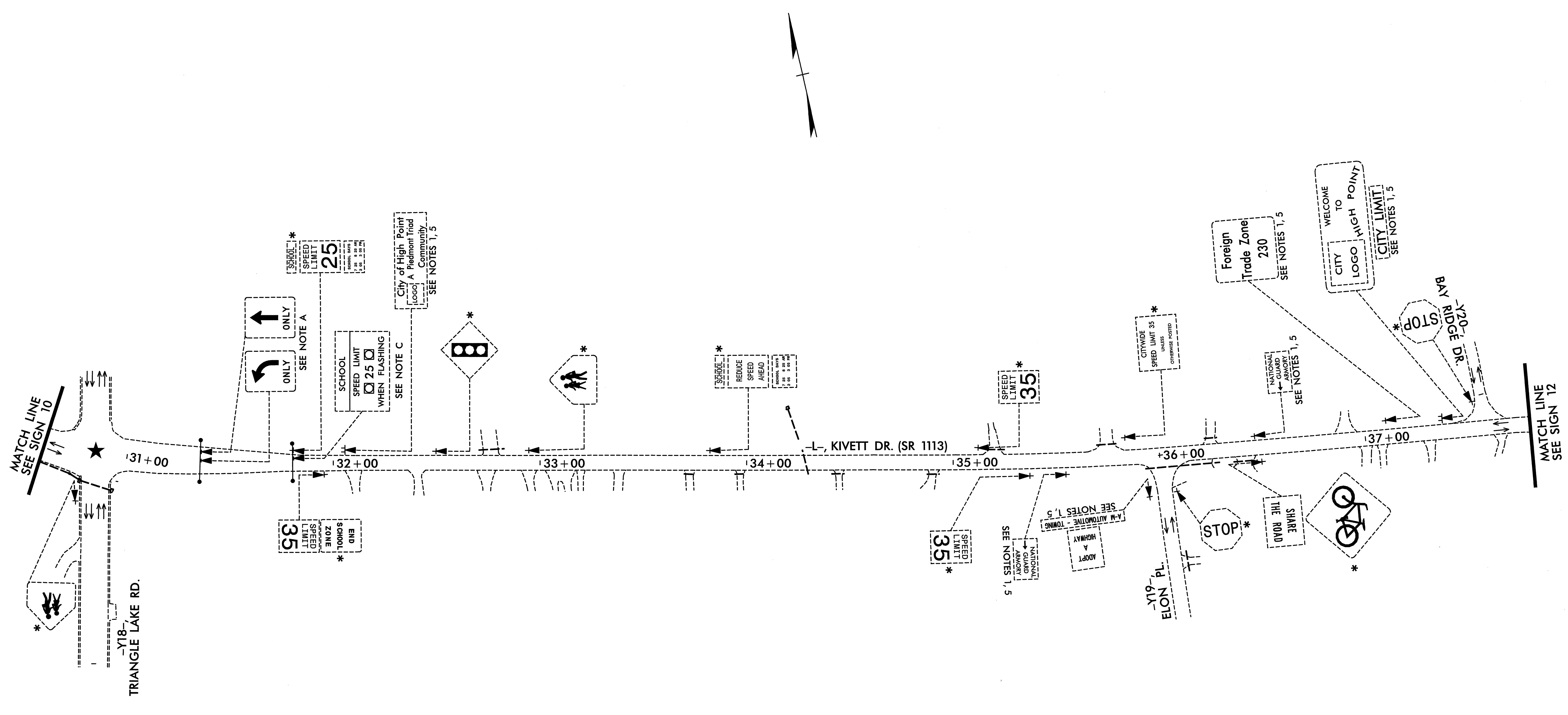

STATE	PROJECT NO.	SHEET NO.	TOTAL SHTS.
N. C.	U-2717	SIGN 11	
F.A. PROJECT NO.			



- ★ INDICATES SIGNALIZED INTERSECTION
- * SEE NOTE 3

Plans prepared by:
KO & ASSOCIATES, P.C.
 Consulting Engineers
 101 SCHAUB DR., SUITE #202
 RALEIGH, N.C. 27606
 For Division of Highways

APPROVED: *Mark Acuff* DATE: 06-08-04

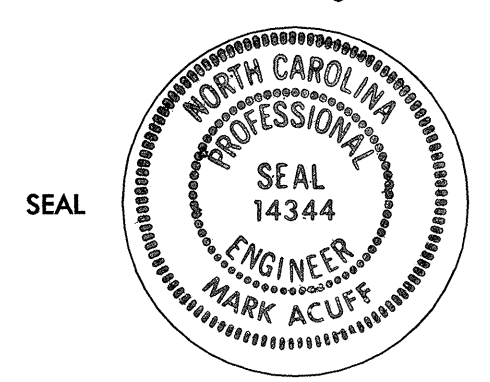

EXISTING SIGNS
 STA. 30+60 TO STA. 37+80
 -L-, KIVETT DR. (SR 1113)

SCALE:	NONE	N. C. DEPARTMENT OF TRANSPORTATION	REVISIONS
DATE:	06-08-04		
SIGNING TECHNICIAN:	B.L.M.		DIVISION OF HIGHWAYS
SIGNING PROJ. DESIGN ENG.:	G.E.P.		TRAFFIC ENGINEERING BRANCH
SIGNING PROJECT ENG.:	M.S.A.		

P:\SIGNING\U-2717\001\PLANS\ESD449p
 05/26/2004 10:20:05 AM