

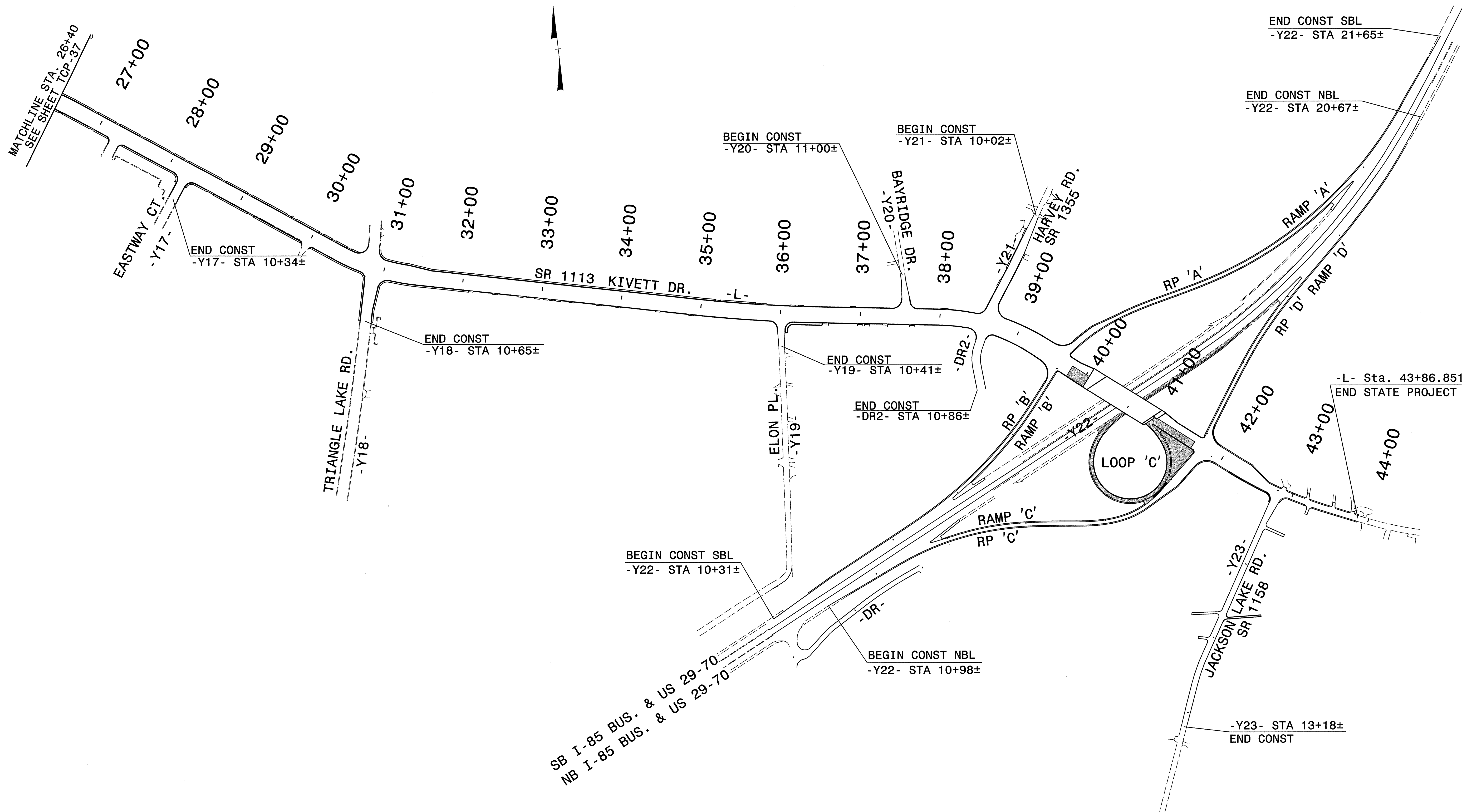

PROJ. REFERENCE NO.	SHEET NO.
U-2717	TCP-38



END CONST SBL
-Y22- STA 21+65±

END CONST NBL
-Y22- STA 20+67±

END CONST
-Y17- STA 10+34±

END CONST
-Y18- STA 10+65±

BEGIN CONST
-Y20- STA 11+00±

BEGIN CONST
-Y21- STA 10+02±

END CONST
-Y19- STA 10+41±

END CONST
-DR2- STA 10+86±

BEGIN CONST SBL
-Y22- STA 10+31±

BEGIN CONST NBL
-Y22- STA 10+98±

-L- Sta. 43+86.851
END STATE PROJECT U-2717

-Y23- STA 13+18±
END CONST

SB I-85 BUS. & US 29-70
NB I-85 BUS. & US 29-70

Plans prepared by:
KO & ASSOCIATES, P.C.
Consulting Engineers
101 SCHAUB DR., SUITE #202
RALEIGH, N.C. 27606
For Division of Highways

APPROVED: *Michael Rzepka* DATE: 6-12-04

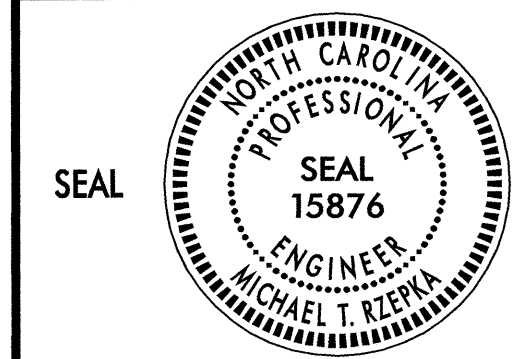

**PHASE IV OVERVIEW
SHEET 2 OF 2**

SCALE: NONE
DATE: 6-04
DWG. BY: MTR
DESIGN BY: MTR
REVIEWED BY: MSA

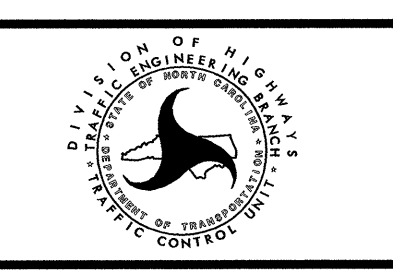

REVISIONS	

p:\traffic\104-277\1002\plans\p4\hbw\dwg
 06/02/2004 01:40:18 PM